



# YOSHIMURA

RESEARCH&DEVELOPMENT OF AMERICA, INC.

5420 DANIELS STREET STE A, CHINO CA., 91710 · (800) 634-9166 · (909) 628-4722 · FAX (909) 591-2198

[www.yoshimura-rd.com](http://www.yoshimura-rd.com)

## **FENDER ELIMINATOR KIT**

**070BG139920**  
**Yamaha MT-09**

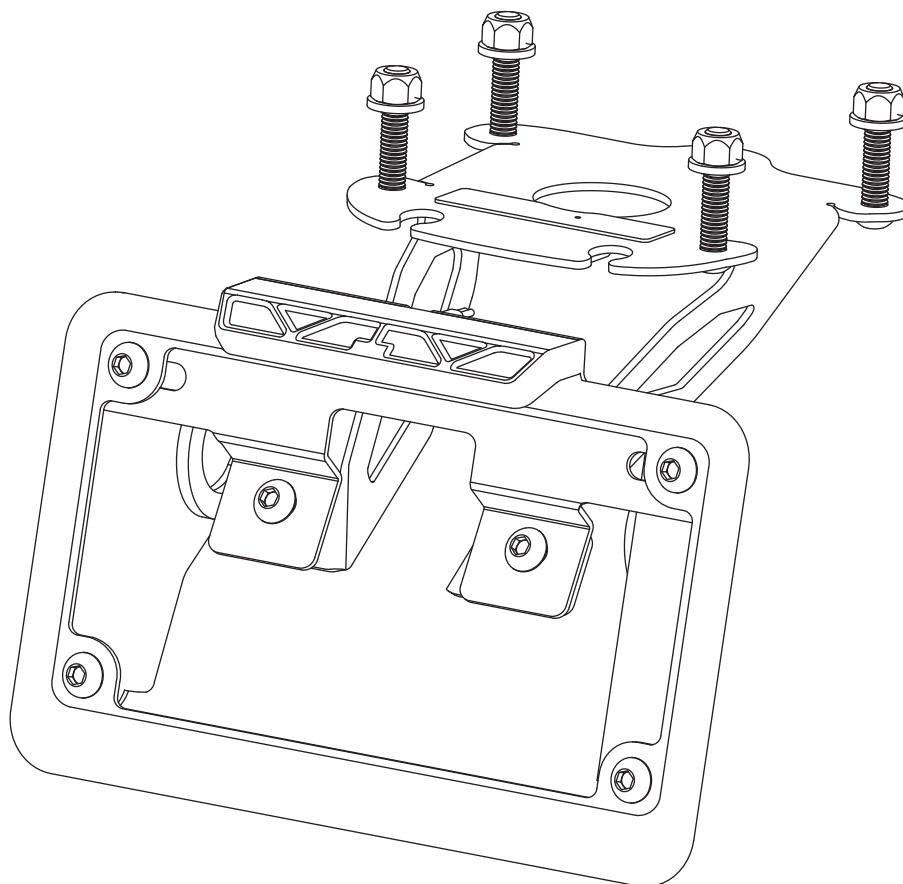

**THIS PRODUCT IS NOT DOT APPROVED.**

Yoshimura R&D of America, Inc. is not liable or responsible for any resulting event caused by the installation of this product. Check with local laws and regulations for compliance prior to installation and use. This product is not intended for use on public highways.



## Assembly Diagram

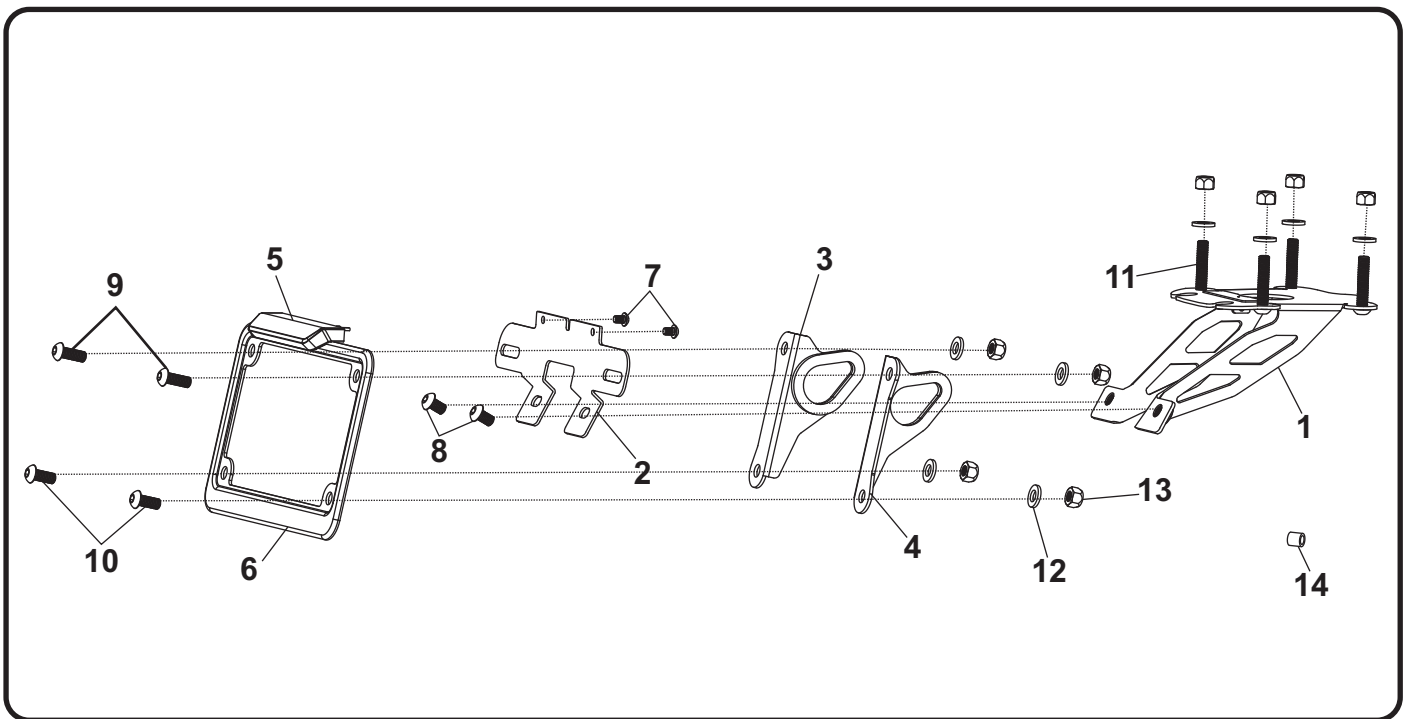

No.	Item	Description	Qty.
1	13992-FEBKT	Fender Eliminator Bracket	1
2	070BG-UNV-FEBKT	License Plate Bracket	1
3	13992-TSB-L	Left Turn Signal Bracket	1
4	13992-TSB-R	Right Turn Signal Bracket	1
5	070BG-LH-K1	LED License Plate Light	1
6	070BG-LPF	License Plate Frame	1
7	M4X6BHS	4mm x 6mm Button Head Screw	2
8	M6X10BHS	6mm x 10mm Button Head Screw	2
9	M6X16BHS	6mm x 16mm Button Head Screw	2
10	M6X14BHS	6mm x 14mm Button Head Screw	2
11	M6X30BHS	6mm x 30mm Button Head Screw	4
12	6MMWASHER	6mm Washer	8
13	6MMLN	6mm Nylon Lock Nut	8
14	13992-FEBKTSPCR	Pin Spacer	1
**	BN-SSS-22-18	Solder Shrink Connectors	2
**	17100	Yoshimura Sticker Sheet	1
Optional Parts			
	070BGUNVTBKT	Universal Turn Signal Bracket Kit	
	072BGLTSFK-S	Sequential Turn Signal	
	070BG12121TSBKT	Corner Turn Signal Bracket	
	073BG-YAM-3	Yamaha Plug-N-Play Turn Signal Adapters	
	073BG-YAM-4	Yamaha Plug-N-Play Turn Signal Adapters	

\*\*\* The Yoshimura Universal Turn Signal Bracket Kit is to be used with aftermarket stud-mounted turn signals and is sold separately.

## Removal

1. Remove seat.
2. Remove seat lock bracket to access stock fender bolts.
3. Locate and disconnect license plate light and rear turn signal connectors.
4. While supporting the stock fender assembly, remove the four fender bolts and carefully remove the fender assembly making sure not to damage turn signal connectors.
5. Disassemble and remove seat key cover. The stock pin, spring, and circle clip will be re-used.

Note: Make note of the spring tension location on the key cover to make reinstallation easier.

6. Disassemble and remove left and right turn signals from the stock fender assembly as turn signals will be re-used.

Note: The stock fender assembly will not be re-used.

7. Cut the stock license plate light connector wires on the stock fender assembly side. Be sure to cut at least a 6" section of wire from the connector.

## Installation

1. Install (No. 5) *070BG-LH-K1*, license plate light onto (No. 2) *070BG-UNV-FEBKT*, license plate bracket using (No. 7) *M4X6BHS*, 4mm button head screws.

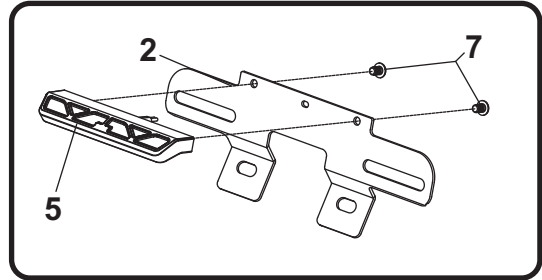

2. Using the *BN-SSS-22-18*, solder shrink connectors provided in the kit, connect the Yoshimura license plate light wires to the stock license plate light wires as follows:

Blue w/ Red Stripe -to- Red Wire  
Black Wire -to- Black Wire

- a) Strip the stock fender light wire ends 1/4" - 1/2" and insert into *BN-SSS-22-18*, solder shrink connector provided in the kit.
- b) Center the spliced wire ends in the middle and using a heatgun or lighter, apply heat evenly on the outer edges of the solder shrink connector to shrink and hold wires in place.
- c) Making sure that the stripped ends are centered, heat the center of the solder shrink connector evenly until the solder begins to liquify.
- d) Allow to cool completely and tug both ends of the wires to verify that connection is secured.

Scan for link to solder shrink connector instruction video.



3. Install the stock turn signals onto (No. 3,4) *13992-TSBL/R*, left and right turn signal brackets using the stock hardware.

4. Install stock key cover spring onto (No.1) 13992-FEBKT, fender eliminator bracket by placing the long side of the stock spring in the spring tension hole on the fender eliminator bracket.

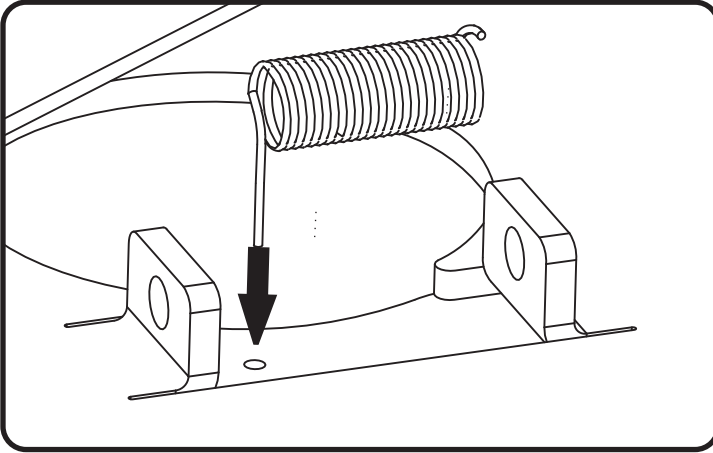

Note: The spring needs to sit flush with the fender eliminator bracket. Place the bracket on a flat surface and lift it.

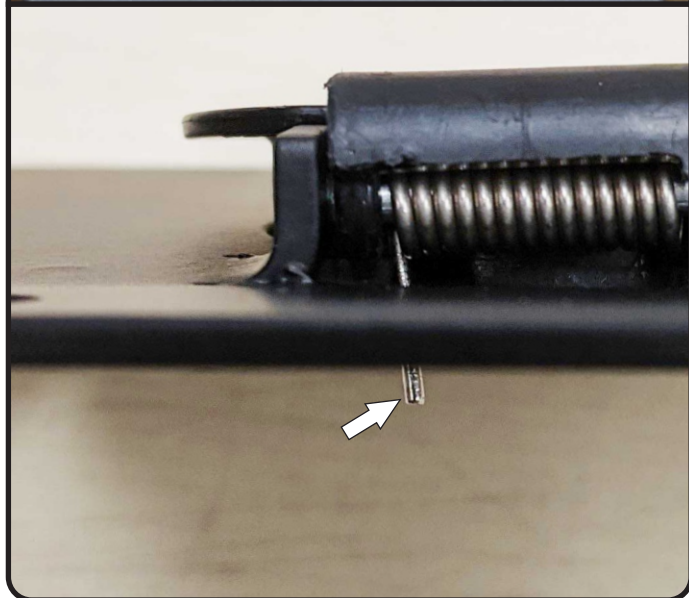
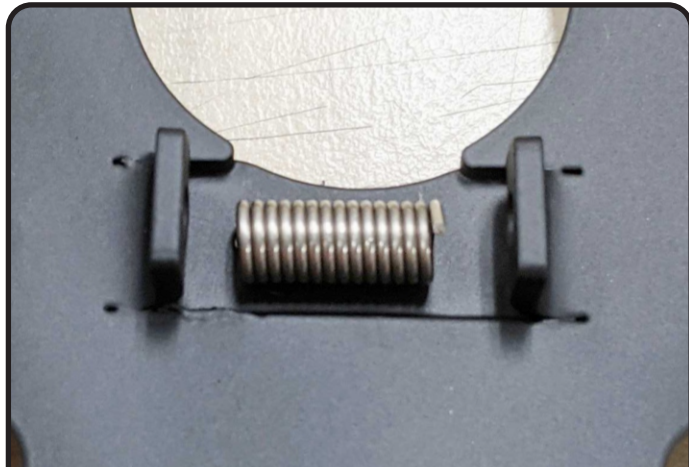

5. Locate the stock spring tension location on the key cover cap as shown in the diagram.



6. Have the OEM pin nearby to get ready for installation. Slide the key cover over the spring and keep pressure on the spring and cover.

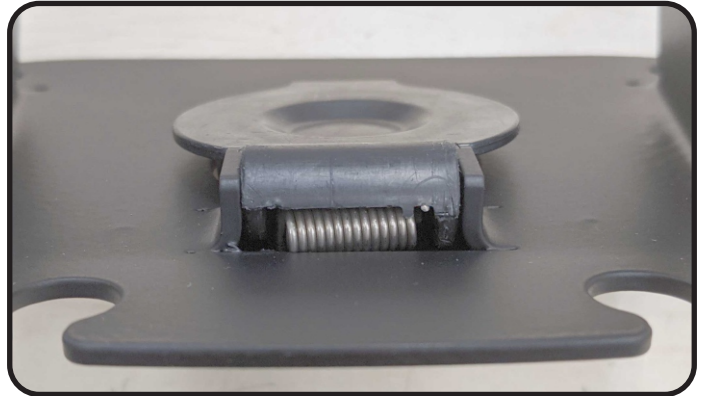

5. Keep the key cover and spring aligned with the pin mounting holes on the fender while sliding the OEM pin through the mounting holes.

Note: Make sure the spring does not move while installing the OEM pin or the tension will be lost and the cap will not snap close. This could result in it moving while riding.

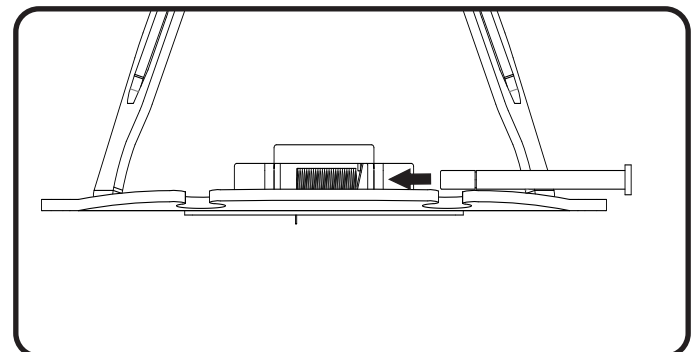

6. Slide the (No.14) 13992-FEBKTSPCR, pin spacer onto the OEM pin and then install the stock circle clip.

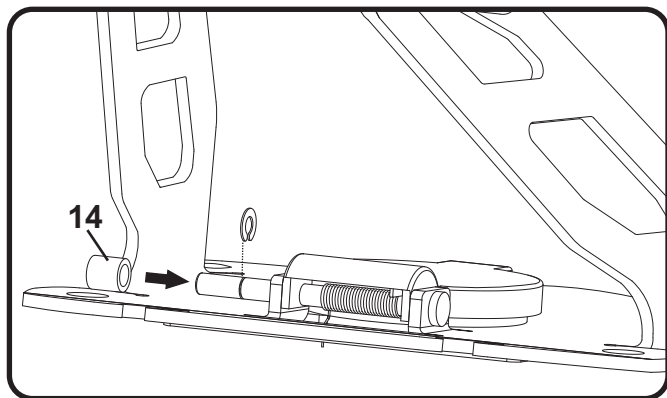

7. Install (No. 2) 070BG-UNV-FEBKT plate bracket onto (No. 1) 13992-FEBKT, fender eliminator bracket using (No. 8) M6X10BHS, 6mm button head screws.

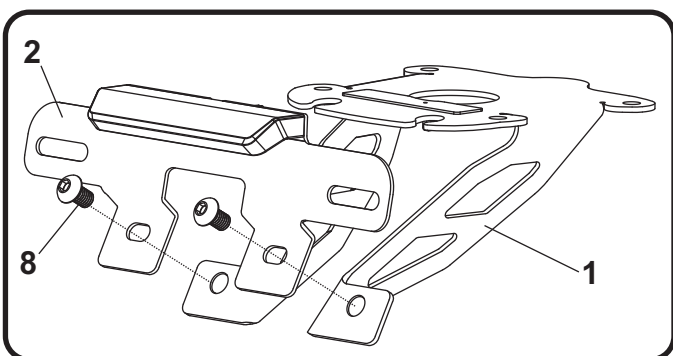

8. Install (No. 3,4) 13992-TSBL/R, turn signal brackets and (No. 6) 070BG-LPF, license plate frame using the (No. 9,10) M6X16BHS and M6X14BHS, 6mm button head screws. Secure using (No. 12,13) 6MMWASHER and 6MMLN, washers and nuts as shown below.

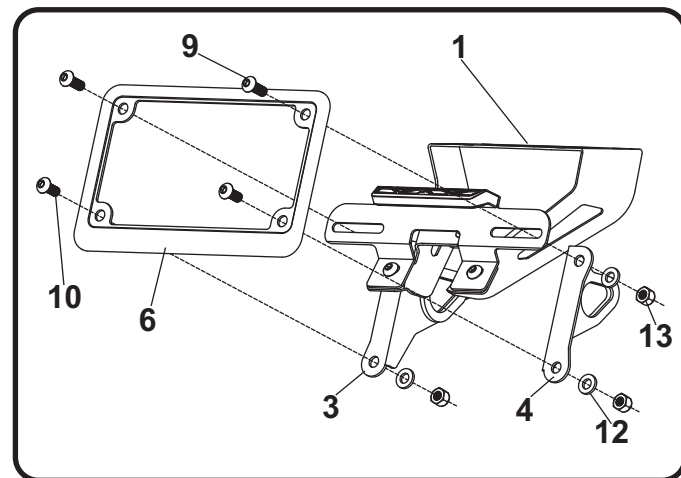

9. Install assembled fender eliminator bracket using (No. 11) M6X30, 6mm hex head bolts, (No. 12,13) 6MMWASHER and 6MMLN, washers and nuts.

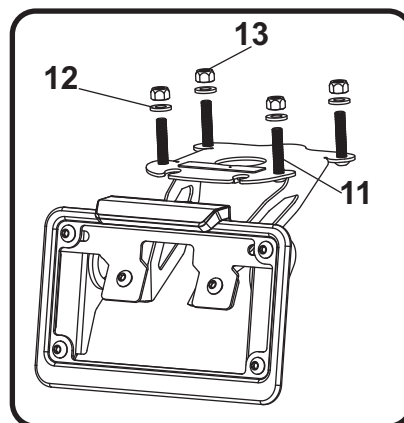

10. Route license plate light and turn signal wires through cutouts on the fender eliminator bracket and reconnect connectors.

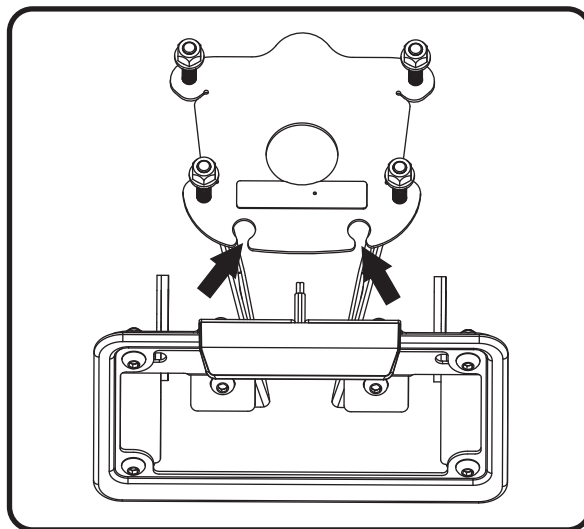

12. Check for proper function of license plate light, turn signals, brake light, and that all brackets and components are secure prior to riding.