

WOODCRAFT CFMOTORSPORTS

105 Baldwinville Rd. Winchendon, MA 01475

(978) 297-2977

MV Agusta F3/Brutale 675/800 GP/STD Rearset Instruction Sheet

Thank you for selecting CFMOTORSPORTS rearsets. The components you have just purchased for your motorcycle are designed to improve the ground clearance, crash worthiness and overall good looks of your motorcycle. Please note that these components are intended and approved for **racing use only**. As such, the foot pegs are solid-mount and brake light switches and pedal return springs are not provided. If desired, this kit uses an 03-0100 brake light switch and 07-7125 brake return spring. This kit also requires the removal of the OEM kickstand. **NOTE: This kit will only work for the Brutale 675/800RR models.**

- 1) Remove stock rearsets, footpegs and associated hardware. All components that are re-used in this kit should be cleaned and inspected for damage before re-installation.

IMPORTANT

Tighten all fasteners to factory specification or industry standard. FAILURE TO PROPERLY TIGHTEN ALL FASTENERS MAY CAUSE DAMAGE TO THE MOTORCYCLE, LOSS OF CONTROL AND SERIOUS INJURY OR DEATH

Brake Side Assembly Installation

- 1) Bolt the CFM footpeg to the bracket using the included **10x35mm FH** hardware. Rotate the eccentric to the desired foot position – be sure to put both pegs in the same location. **IMPORTANT** - Secure bolt with **BLUE LOCTITE** once position is final.
- 2) Bolt the heel guard in place using the OEM or included **6x16mm BH** hardware.
- 3) Bolt the brake bracket assembly to the frame using the **OEM hardware**, placing the included spacers between the bracket and the frame if needed. Several aftermarket exhaust manufacturers incorporate a bracket that bolts between the rearset bracket and the frame, and these washers are needed for proper clearance with select brands.
- 4) Secure the exhaust system to the bracket using the OEM hardware and rubber pieces (if required for your system)
- 5) This kit uses the OEM MV brake pedal. Adjust the pedal height to your desired location using the OEM adjusters.

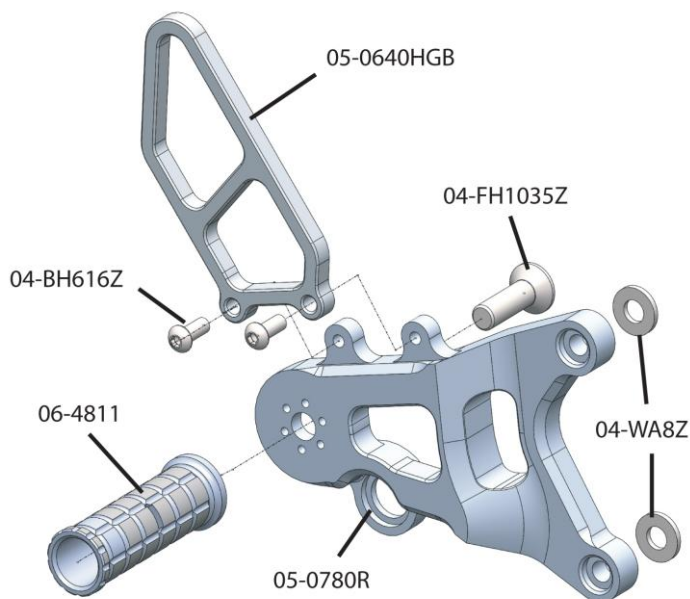

Shift Side Assembly Installation

- 1) Bolt the CFM footpeg to the bracket using the included **10x35mm FH** hardware. Rotate the eccentric to the desired foot position – be sure to put both pegs in the same location. **IMPORTANT** - Secure bolt with **BLUE LOCTITE**.
- 2) Attach the heel guard to the bracket using the included **6x16mm BH** hardware. **IMPORTANT** - Secure bolts with **BLUE LOCTITE**.
- 3) Assemble the CFM shift pedal using a threadlocking compound on all bolts except the tip, as this will be completed in step 10.
- 4) See diagram at the right. **Standard shift** - Bolt the heim joint to the pedal using the left hand end of the shift pedal. **GP shift** - Bolt the heim joint to the pedal using the right hand end of the shift pedal. The heim joint is bolted to the shift pivot from the back side **IMPORTANT** - Secure this bolt with **BLUE LOCTITE**.
- 5) This rearset kit can be used with or without the OEM kick stand. The 05-0780SM bracket is either bolted on top of the OEM kick stand using the OEM bolts, or the kick stand may be removed and replaced with the two 05-0780SP2 spacers in the diagram on page 2. Re-torque the OEM bolts to factory specification.
- 6) Secure the CFM lever to the bracket using the supplied **8x40mm** bolt, spacer sleeve and wave washer. Be sure to generously apply quality waterproof grease to the sliding surface of the spacer to ensure smooth lever operation. **IMPORTANT** - Secure this bolt with **BLUE LOCTITE**.

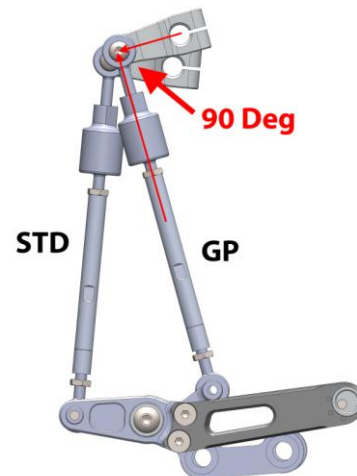

- 7) Bolt the shift bracket assembly to the frame with OEM bolts.
- 8) Install the CFM shift rod (use the locknuts from the **OEM rod**). Bring the pedal to the desired height and lock in place.
- 9) Rotate the upper shift arm on to the shift spline roughly to 8 o'clock and secure the hiem joint to the arm using the supplied **6x35mm BH** hardware, placing the included spacer between the arm and the hiem joint at the top joint. **IMPORTANT** - Secure the bolt with **BLUE LOCTITE**. **IMPORTANT** - the shift rod should make roughly a 90 degree angle with both the upper shift arm and shift pedal. **NOTE**: secure the wires for the quickshifter with zip ties so they are out of the way of moving parts.
- 10) Adjust the lever tip and shift rod to the position where the distance from the peg to the lever tip is most comfortable and then secure the tip with **BLUE LOCTITE**. Be sure to lock the shift rod in place using both lock nuts.

BE SURE THAT ALL COMPONENTS OPERATE AND RETURN FREELY BEFORE USE

If you have any questions regarding installation, please feel free to contact us.

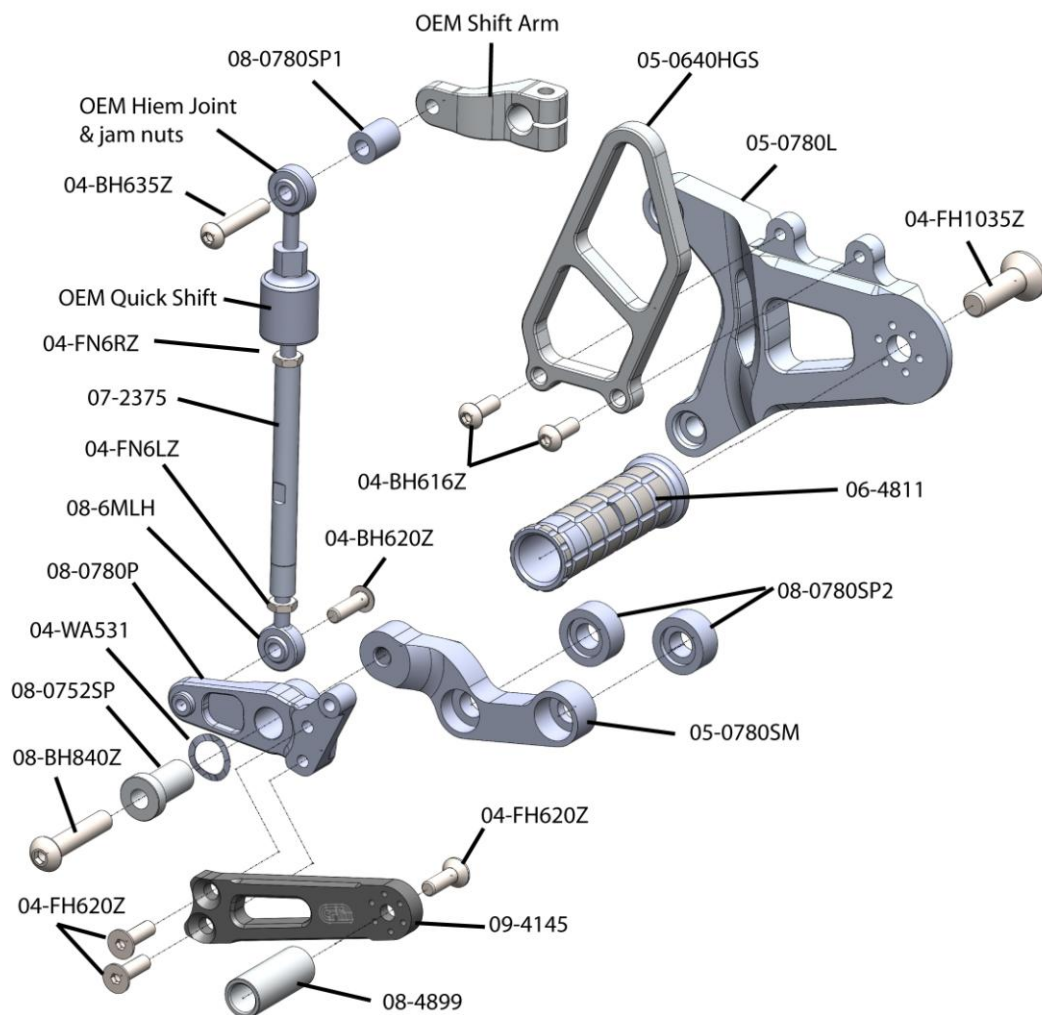

IMPORTANT Installation and use of this product will change the response of the motorcycle to rider control inputs.

Failure of the rider to adapt to these changes may result in a loss of control, and serious injury or death. Improper installation and/or failure to comply with all warnings and instructions may cause a loss of control and serious injury or death. **DO NOT INSTALL OR USE THIS PRODUCT IF YOU ARE UNABLE TO DO SO IN COMPLIANCE WITH ALL INSTRUCTIONS AND WARNINGS. SEEK THE ASSISTANCE OF A PROFESSIONAL TECHNICIAN.**