

1) The sliders will use the two most forward engine mount on each side. Completely install the sliders one side at a time – never loosen both sides at the same time, or your engine may move and you will have to jack it back in place to ensure proper alignment for re-installation.

## Right Side

2) With a cold engine, drain the coolant from the motorcycle using the drain bolt on the water pump cover. Remove the lower clamp of the radiator hose on the right side of the engine, and remove the hose from the top side of the water pump. The hose can stay attached to the radiator.

3) Attach the 50-0790RI to the motorcycle using the 10mm bolts provided, threading them in place of your motor mount bolt on each side.

**Woodcraft recommends using anti-seize on these bolts and to torque them to about 35 ft-lbs.** Attach the 50-0790R puck base using the 04-SC1025F bolt using Blue Loctite and torque to about 35 ft-lbs.

**WARNING:** Since motor mount bolts are steel bolts going into an aluminum engine, it is easy to cross thread them and damage the threads. Always start the first few turns by hand before using a ratchet on the bolt.

4) Re-attach the radiator hose, replace the water pump drain bolt and re-fill the bike with coolant.

5) Slide the plastic slider over the top of the base and secure in place using the 8 mm countersunk bolt provided. The bolt passes first through the non threaded side of the aluminum base and then screws into the threaded hole on the far side of the base. The plastic puck is undersized on the far side of the slider to act as a lock for the bolt

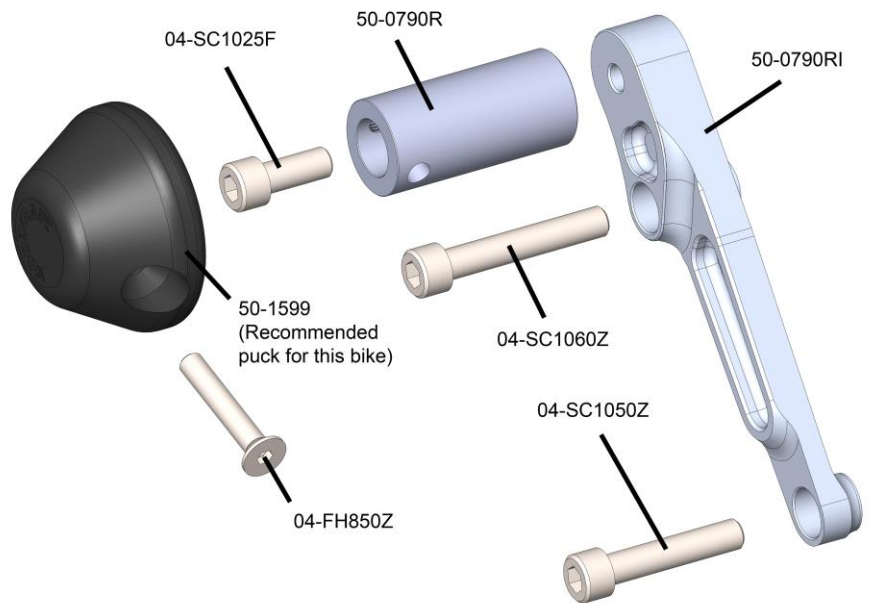

## Left Side

1) Attach the 50-0790LI to the motorcycle using the 10mm bolts provided, threading them in place of your motor mount bolt on each side.

**Woodcraft recommends using anti-seize on these bolts and to torque them to about 35 ft-lbs.**

Attach the 50-0790L puck base using the 04-SC1025F bolt using Blue Loctite and torque to about 35 ft-lbs.

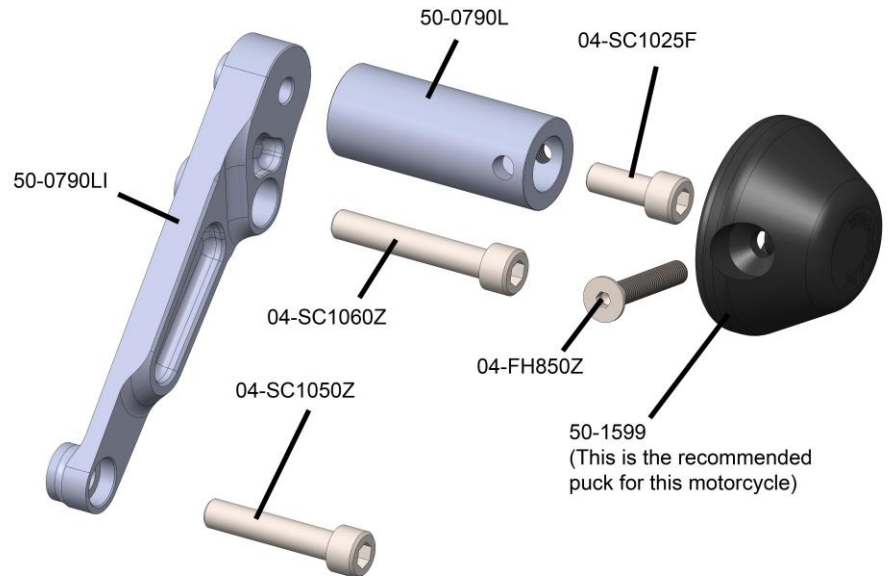

**WARNING:** Since motor mount bolts are steel bolts going into an aluminum engine, it is easy to cross thread them and damage the threads. Always start the first few turns by hand before using a ratchet on the bolt..

3) Slide the plastic slider over the top of the base and secure in place using the 8 mm countersunk bolt provided. The bolt passes first through the non threaded side of the aluminum base and then screws into the threaded hole on the far side of the base. The plastic puck is undersized on the far side of the slider to act as a lock for the bolt

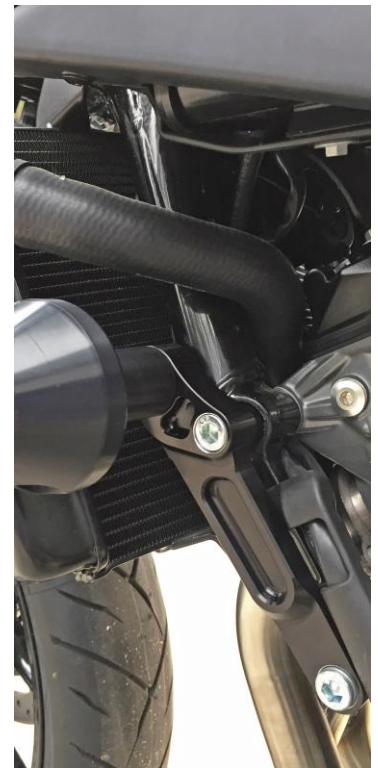

**105 Baldwinville Rd Winchendon, MA 01475 978-297-2977**

WARNING: Improper installation and/or failure to comply with all warnings and instructions may cause a loss of control and serious injury or death. The motorcycle should be run and thoroughly inspected before use. DO NOT INSTALL OR USE THIS PRODUCT IF YOU ARE UNABLE TO DO SO IN COMPLIANCE WITH ALL INSTRUCTIONS AND WARNINGS. SEEK THE ASSISTANCE OF A TRAINED PROFESSIONAL TECHNICIAN.