

V3 FRAME SLIDERS KIT 2.0

YAMAHA YZF R3

year of production: ALL
product code: SR187

Assembly position
Both sides

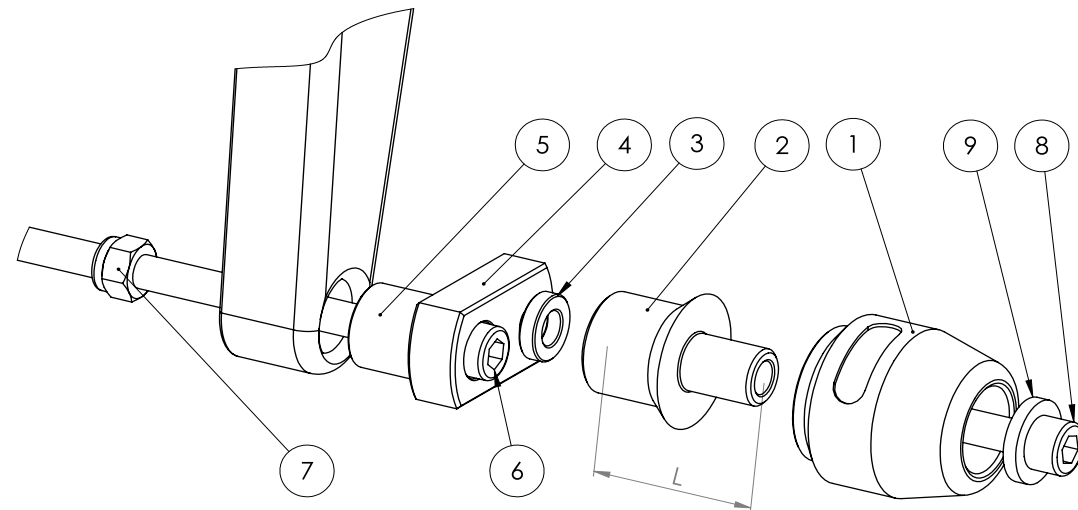

Dimensions
of the spacers

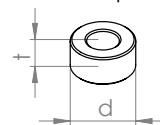

Assembly instructions

1. Put the labels with Vortex logo onto the sliders.
 2. Remove the screws indicated with the arrows.
 3. Using screws #7 and spacers #5 mount middle bars #4 as shown in the drawing. Position the bars perpendicular to motorcycle's drive direction.
 4. Assemble sliders #1, adapters #2 and spacer #3 putting them on the screw #10 as shown in the drawing.
 5. Assemble the screws #10 together with the sliders to the bars #4.
- We suggest to use the threadlocker to make sure that the screws do not get loose.

This product is a professional accessory to be used on the race track. Manufacturer and Seller take no responsibility for any damages occurred despite of using protective accessories.

For more information go to vortexracing.com

No	PART	LEFT SIDE	RIGHT SIDE
1	Slider		
2	Adapter	L = 80 mm	L = 80mm
3	Spacer	d=20 mm, t=5 mm	d=20 mm, t=5 mm
4	Middle bar		
5	Spacer	d=20 mm, t=15 mm	d=20 mm, t=5 mm
6	Spacer	none	none
7	Mounting bolt	M10, L = 70 mm	M10, L= 60 mm
8	Mounting bolt	none	none
9	Nut	none	none
10	Screw	M10, L=100	M10, L=100
11	Washer	none	none
12	Adjusting washers	none	none