



YOSHIMURA

RESEARCH&DEVELOPMENT OF AMERICA, INC.

5420 DANIELS STREET STE A, CHINO CA., 91710 · (800) 634-9166 · (909) 628-4722 · FAX (909) 591-2198

www.yoshimura-rd.com

RACE SERIES

Qualified Manufacturer Declared "Modified Part"

2008~2012

Kawasaki Ninja 250R

1407072 (CF/CF)

1407075 (SS/CF)

TRC Stainless Steel Full-System

FOR CLOSED COURSE COMPETITION ONLY; NOT INTENDED FOR STREET USE

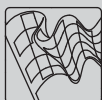

Race Series systems are:

- NOT CARB/EPA tail-pipe emissions compliant.
- NOT street legal.
- For "Closed Course Competition" use only.

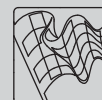

You must know how to remove and replace your stock exhaust in order to install this product otherwise have it installed by a professional mechanic. Keep all stock parts from your existing system as some components may be necessary to install your new Yoshimura exhaust depending on the application. Read through all instructions before beginning installation. Exhaust system can be extremely hot. Let motorcycle cool down before beginning installation. Always wear hand and eye protection and take precautionary measures to avoid injury.



NOTE: IN THE STATE OF CALIFORNIA, IT IS ILLEGAL TO MODIFY THE EMISSION CONTROL SYSTEM, WHICH INCLUDES THE CARBURETORS OF ANY VEHICLE.

Caution: Exhaust system can be extremely hot. Let motorcycle cool down before beginning installation.

Note: Read through all instructions before beginning installation.

Tools Needed:

Metric Socket Set
Allen Socket Set
3/8" Ratchet and Extension
Metric Combination Wrench Set
Torque Wrench

Installation Steps:

1. Remove the front lower right plastic bodywork.
2. Remove the stock heatshield (see Fig. 1 for stock heatshield fastener locations).
3. Loosen the stock exhaust clamp (see Fig. 2).
4. Remove the stock muffler mount bolt and remove the stock muffler (see Fig. 1 for stock muffler mount bolt location).
5. Remove the stock header by removing the four stock header nuts (see Fig. 3 for stock header nut locations).
Note: 2010 models have a header bracket. Remove nut and bolt for this bracket to remove header.
6. Remove the stock exhaust port gaskets (the stock exhaust gaskets will most likely remain on the stock header when the stock header is removed).
7. Install new stock exhaust port gaskets onto the Yoshimura header (new stock exhaust port gaskets are not supplied).
8. Install the Yoshimura header using the stock header nuts.
9. Install the rubber heat insulator onto the inside of the muffler clamp and slide the muffler clamp onto the muffler.
10. Install the Yoshimura muffler and tailpipe onto the Yoshimura header. Secure the tailpipe bracket with stock hardware. Do not tighten at this point.
11. Mount the Yoshimura full system to the outside of the stock passenger footrest using the stock hardware. The large stock chrome washer moves from the outside of the passenger footrest to the inside of the passenger footrest (see Fig. 4).

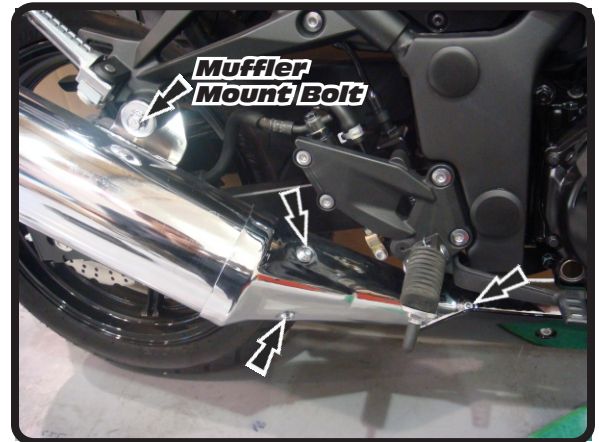

Fig. 1

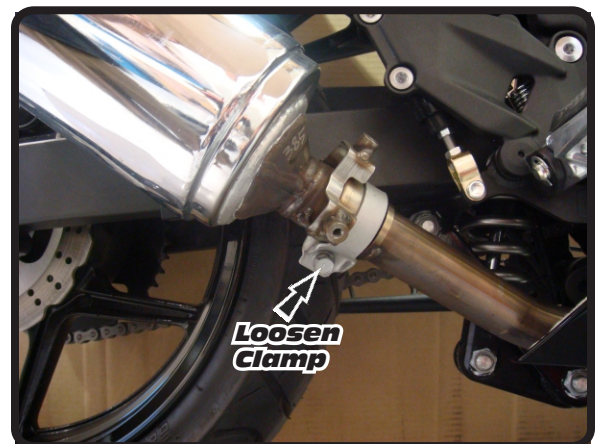

Fig. 2

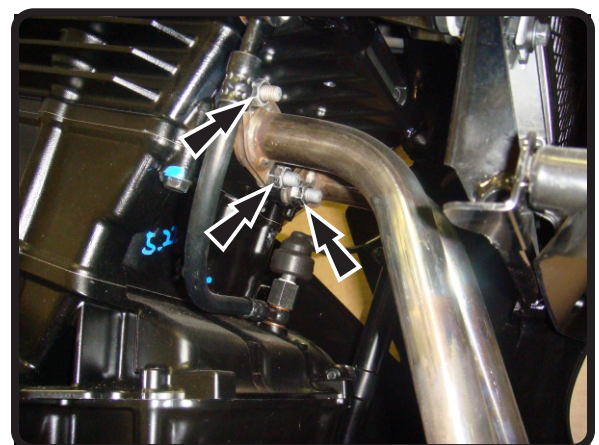
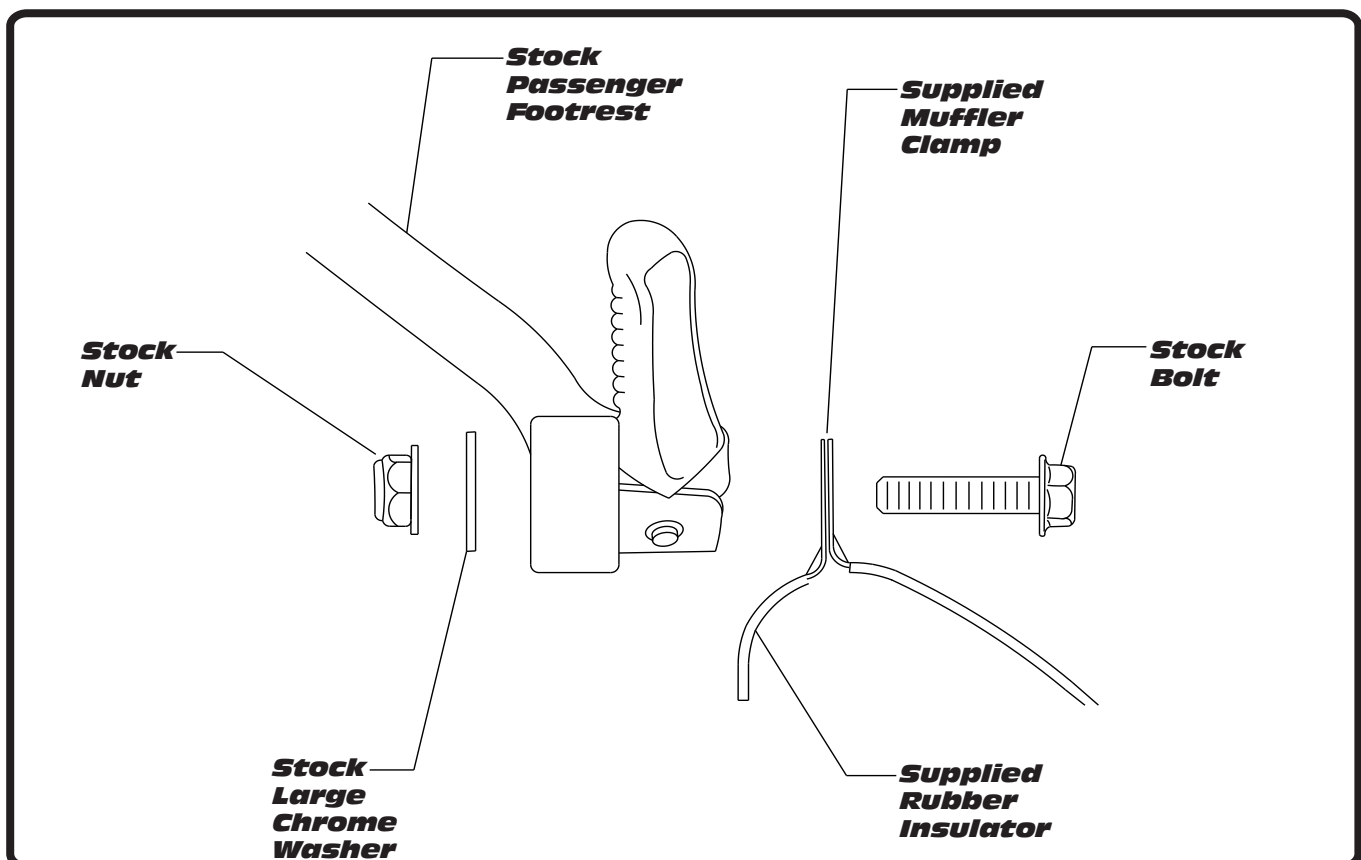

Fig. 3

12. Install the two supplied medium exhaust springs between the header and tailpipe.
13. Standing at the back of the motorcycle, check for proper alignment of the muffler. Adjust if necessary.

NOTE: To adjust fitment, it may be necessary to rotate the tailpipe or the muffler independently until proper alignment of the muffler is achieved.
14. Torque the stock header nuts and tailpipe bracket to 1.25 kgf-m (9 lb-ft).
15. Torque the stock muffler mounting bolt to 2.5 kgf-m (18 lb-ft).
16. Install the Yoshimura heatshield onto the Yoshimura tailpipe using the supplied heatshield bolts. Line up the heatshield so that there is a uniform gap between the muffler and the heatshield.
17. It is recommended that the entire exhaust system be wiped down with rubbing alcohol to remove oil and fingerprints. This will help prevent tarnishing of the finish after the exhaust is heated up.
18. Reinstall the front lower right bodywork.
19. Before starting the motorcycle, check for proper clearance between the new exhaust system and the motorcycle (i.e. swingarm, fairings etc.). If any problem is found, please carefully follow through the installation steps again. If the problem still persists, please call the Yoshimura technical department at (800) 634-9166 or (909) 628-4722 in California.

**Fig. 4**

#140707(2,5,7)

S = STOCK

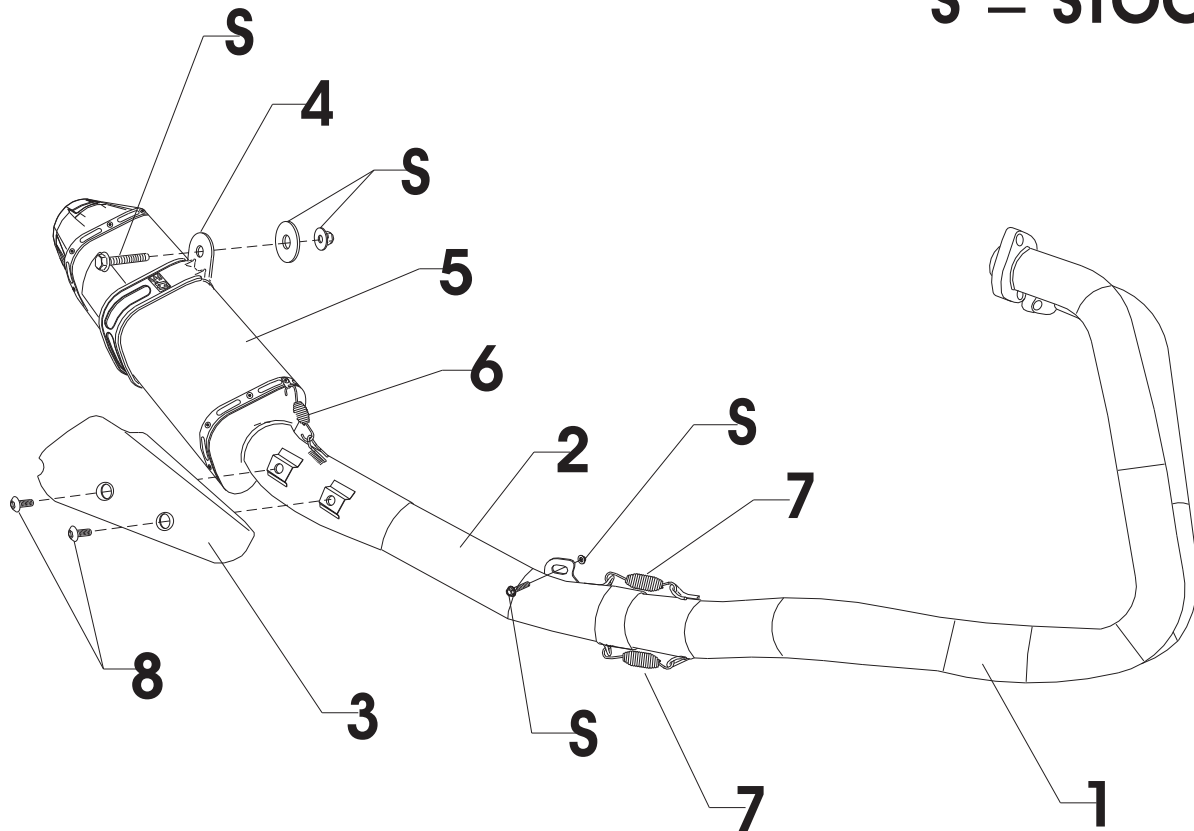

Parts Diagram

NO.	DESCRIPTION	QTY	PART #
1	Yoshimura Full System Header	1	1407-401
2	Yoshimura Full System Tailpipe	1	1407-419
3	Yoshimura Stainless Steel Heatshield	1	1407272-HS
4	Yoshimura Stainless Steel Muffler Clamp Carbon Fiber Sleeve uses Stainless Steel or Titanium Sleeve uses	1	CTS101 CTS101X
5	Yoshimura Race Muffler with Carbon Fiber Sleeve with Stainless Steel Sleeve with Titanium Sleeve	1	1406272-RMA 1406275-RMA 1406277-RMA
6	Small Exhaust Springs	2	RACE-SPX-1
7	Medium Exhaust Springs	2	RACE-SPS-1
8	Heatshield Bolts	2	RC116HSB
**	Muffler Clamp Heatshield	1	HT SHLDTRS
**	Spring Puller	1	ST-200
**	Yoshimura Vinyl Stickers	1	17029