



YOSHIMURA

RESEARCH & DEVELOPMENT OF AMERICA, INC.

5420 DANIELS STREET STE A, CHINO CA. 91710 · (800)634-9166 · (909)628-4722 · FACSIMILE (909)591-2198

www.yoshimura-rd.com

RS-3/RS-1 OVAL PERFORMANCE EXHAUST SYSTEM

HONDA
'01-06
CBR600F4i

121525(2,5,7)-CA

RACE ONLY STAINLESS STEEL SLIP ON SYSTEM

121535(2,5,7)-CA

ZYCLONE STAINLESS STEEL SLIP ON SYSTEM

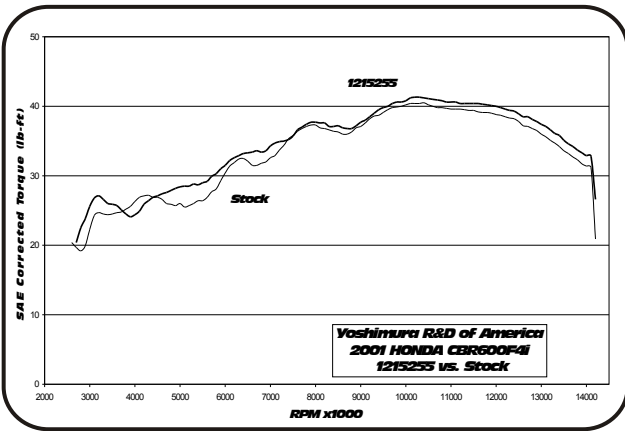
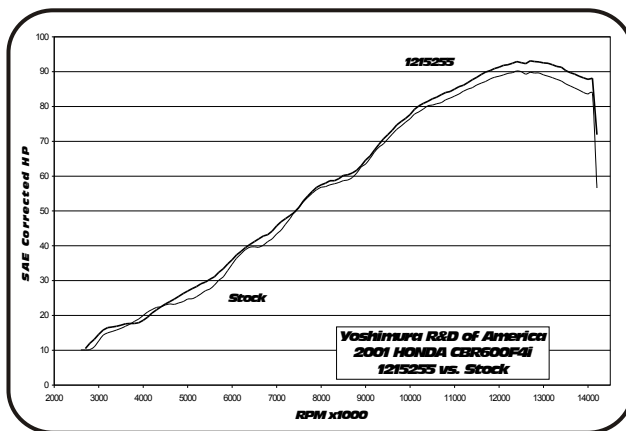

Note: Dyno graphs are for comparison use only. Actual results may vary depending on operating and motorcycle condition.



THIS PRODUCT IS DESIGNED FOR USE IN CLOSED COURSE RACING AND IS NOT INTENDED FOR HIGHWAY USE.



NOTE: IN THE STATE OF CALIFORNIA, IT IS ILLEGAL TO MODIFY THE EMISSION CONTROL SYSTEM, WHICH INCLUDES THE CARBURETORS OF ANY VEHICLE.

Caution: Exhaust system can be extremely hot. Let motorcycle cool down before beginning installation.

Note: Read through all instructions before beginning installation.

Tools Needed:

- 11mm(7/16") and 12mm sockets
- 3/8" ratchet
- 12mm wrench
- 5mm Allen wrench
- Phillips screwdriver
- Torque wrench
- Power drill
- 13/64" drill bit
- Safety glasses

Installation Steps:

- 1 Remove right cowling.
(See Fig. 1 for fastener locations)
- 1a Models with O2 Sensor Only: Unbolt Oxygen Sensor from tailpipe. (See Fig. 2)
- 2 Remove stock muffler and tailpipe assembly.
- 3 Slip supplied 2" stainless steel exhaust clamp over end of Yoshimura tailpipe.
- 4 Install Yoshimura Muffler and tailpipe assembly onto stock header.
- 5 Apply heat insulator to inside of muffler clamp and slide clamp onto muffler.
(Note direction of clamp in Fig. 4)
- 6 Mount clamp to stock muffler bracket using supplied bolt, spacer and stock washer with nut. (see Fig. 4) Hand tighten only at this point.
- 7 Standing at the back of the motorcycle, check the orientation of the muffler (the exhaust tip should be pointing down) and check for clearance between swing arm, rear brake and muffler. (See Fig. 3)
- 8 Tighten muffler clamp bolt to 2.5 kg-m (18 lb-ft).

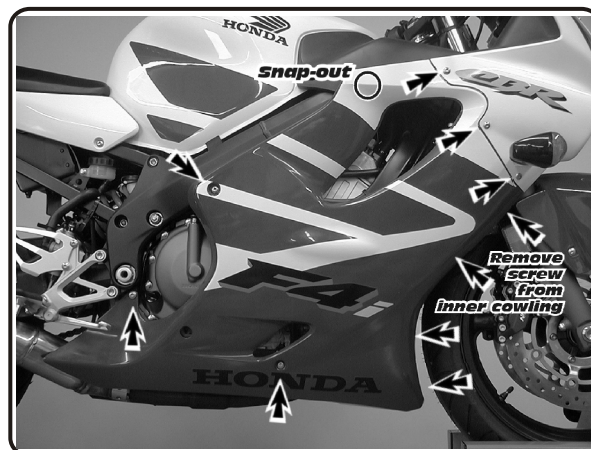

Fig. 1

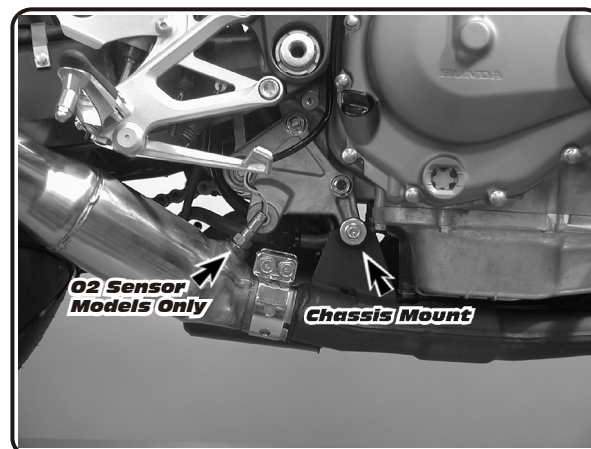

Fig. 2

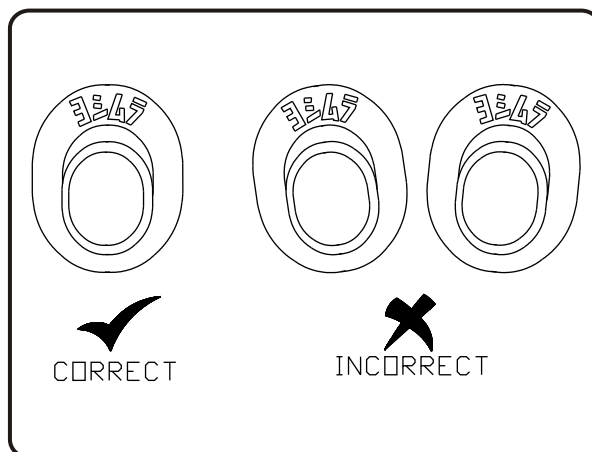
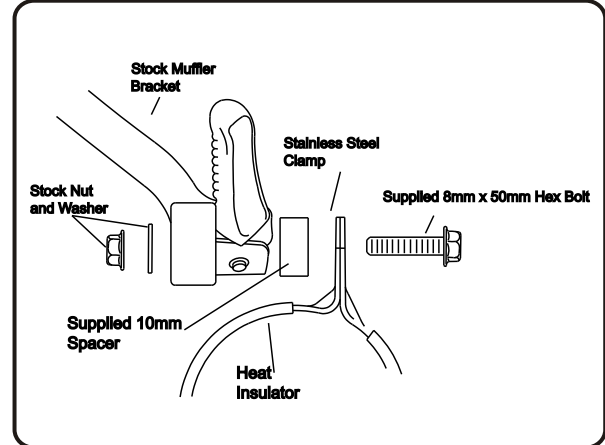
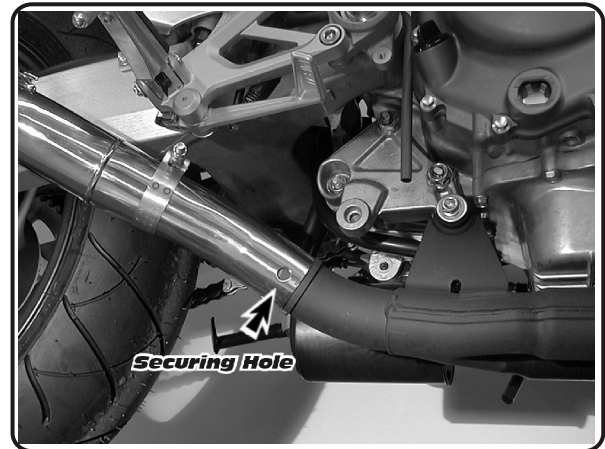

Fig. 3

- 9 *Drill 13/64" hole thru end of header at the center of the securing hole in Yoshimura tailpipe. (See Fig.5) (Caution: Always wear eye protection when using any power tool.)*
- 10 *Install securing rivet into drilled hole, slide 2" stainless steel exhaust clamp over rivet and tighten clamp to 1.25 kg-m (9 lb-ft).*
- 10a *Models with O2 Sensor only: Re-install Oxygen Sensor into Yoshimura midpipe.*
- 10b *Models without O2 Sensor: Plug O2 Sensor Bung with O2 Sensor Plug and Crush Washer (Supplied).*
- 11 *It is recommended that the muffler and tailpipe be wiped down with rubbing alcohol to remove oil and fingerprints. This will help prevent tarnishing of the finish after the exhaust is heated up.*
- 12 *Check for proper clearance between new exhaust system and motorcycle. (i.e. Swing-arm, axle bolt, etc.) If any problem is found, please carefully follow through the installation steps again. If problem still persists, please call Yoshimura technical department at (800)634-9166 / in CA (909)628-4722*
- 13 *Reinstall cowling.*
- 14 *Check for proper clearance between new exhaust system and cowling.*

Note: After starting motorcycle, it is normal for new exhaust system to smoke until oil residue burns off.

**Fig. 4****Fig. 5**

#121525(2,5,7)/121535(2,5,7)

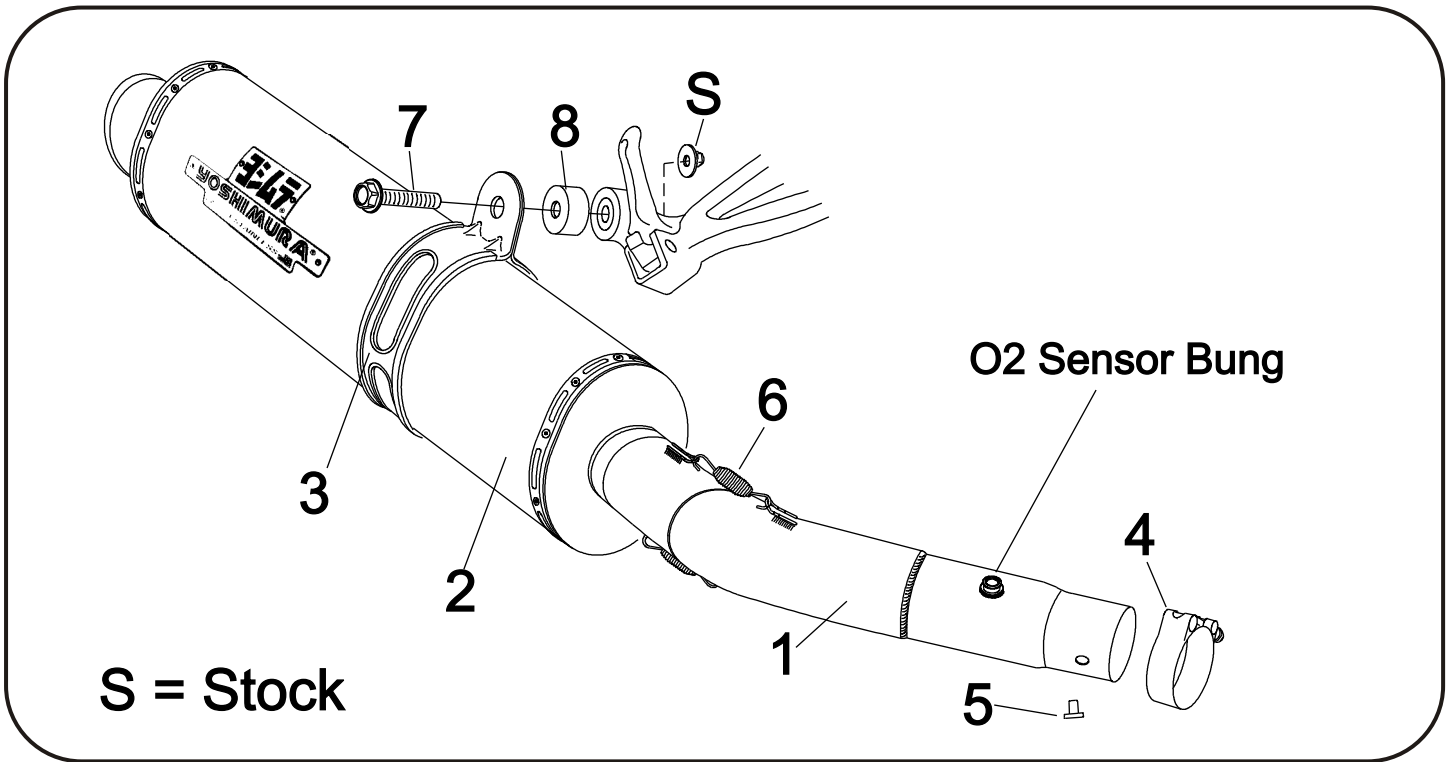

S = Stock

Parts Diagram

NO.	DESCRIPTION	QTY	PART #
1	Yoshimura Stainless Steel tailpipe Non California model use California model use	1	1215-435 1215-435-CA
2	RS-3 or RS-1 Oval Muffer Assembly	1	**
3	Stainless Steel Muffer Clamp Stainless Steel or Titanium Sleeve use Carbon Fiber Sleeve use	1	COS450S8ASX COS450S8AS
4	2" Stainless Steel Exhaust Clamp	1	20062
5	Collector Securing Rivet	1	S-RIVET
6	2.5" Exhaust Spring	2	RACE-SPS-1
7	8mm x 50mm Hex Head Bolt	1	M8X50H
8	10mm Aluminum Spacer	1	8X10SPC
**	Heat Insulator	1	HT SHLDTRS
**	O2 Sensor Plug (For Bikes Without O2 Sensor)	1	M12X8H
**	Crush Washer (For O2 Sensor Plug)	1	12MMCW
**	Yoshimura Vinyl Sticker	2	17028-BLK

Nuts and Bolts Guide (Actual Size):



8mm x 50mm
Flange Hex Bolt