



Fender Eliminator Kit

APPLICATION

YEAR	MODEL
2008-2014	Kawasaki KLX250S/SF
PRODUCT	
070BG143000	Fender Eliminator Kit

 This product is not DOT approved. Yoshimura R&D of America, Inc. is not liable or responsible for any resulting event caused by the installation of this product. Check with local laws and regulations for compliance prior to installation and use. This product is not intended for use on public highways.

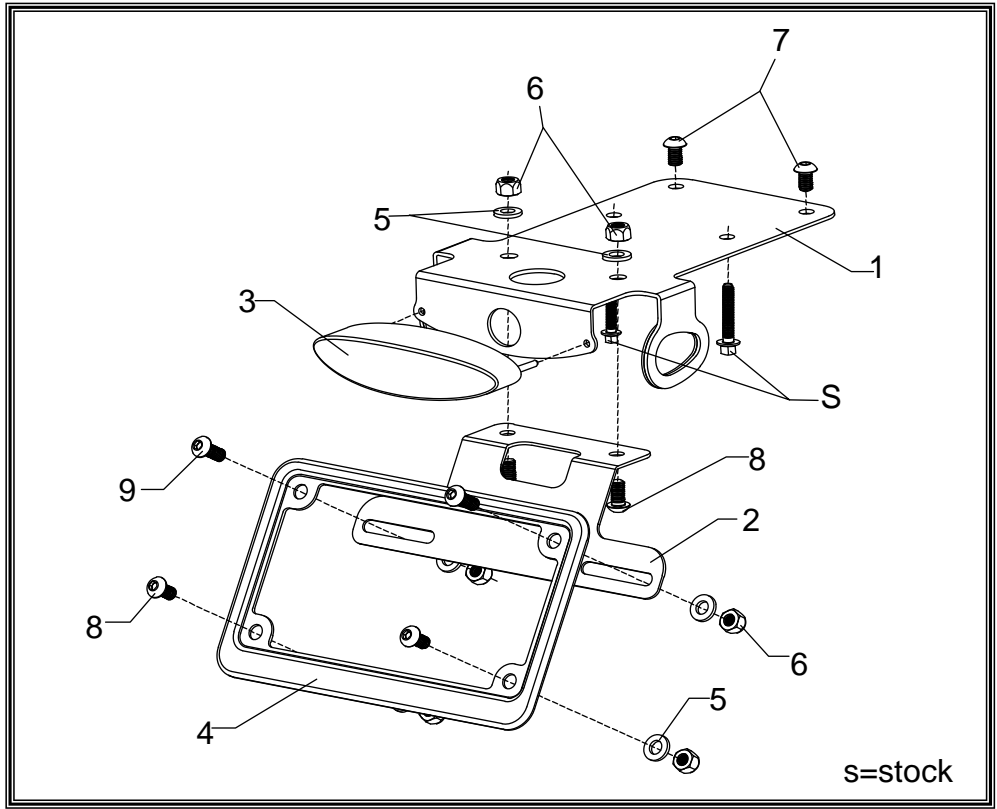

No.	Part #	Description	Qty
1	14300-FEBKT3	Yoshimura Fender Eliminator Bracket	1
2	14300-FEBKT2	Yoshimura License Plate Bracket	1
3	602020-D	Fender Eliminator Tail Light	1
4	070BG-LPF	Yoshimura License Plate Frame	1
5	6MMWASHER	6mm Washer	6
6	6MMLN	6mm Lock Nut	6
7	M6X10BHS	6mm x 10mm Button Head Screw	2
8	M6X12BHS	6mm x 12mm Button Head Screw	4
9	M6X16BHS	6mm x 16mm Button Head Screw	2
**	17029	Yoshimura Sticker Sheet	1

-TOOLS REQUIRED-

Metric Socket Set • Combination Wrench Set • Metric Allen Wrench Set

-REMOVAL-

- 1. Remove left and right side panels by removing the (3) bolts.**
- 2. Remove rider seat.**
- 3. Remove the (2) bolts securing tail to frame.**
- 4. Remove tool bag by removing the (4) bolts.**
- 5. Remove the (2) rear fender bolts from below.**
- 6. Remove tail to access turn signal and license plate light wires.**
- 7. Disconnect left and right turn signal and brake light wires.**
- 8. While securely supporting the stock fender assembly, remove the (2) forward bolts securing stock fender assembly to the frame from the top.**
- 9. Carefully remove stock fender assembly making sure not to damage connectors.**
- 10. Remove stock turn signals from fender assembly.**
Note: Stock mounting hardware will be reused when installing turn signals onto Yoshimura fender eliminator bracket.

-INSTALLATION-

- 1. Install stock turn signals onto Yoshimura fender eliminator bracket using the stock mounting hardware.**
- 2. Assemble and install Yoshimura fender eliminator using the hardware provided in the kit as shown in the parts diagram.**
- 3. Re-connect turn signal connectors and Yoshimura fender eliminator tail light connector to stock harness.**
- 4. Re-install stock tail using the reverse steps of removal.**
- 5. Re-install rider seat.**
- 6. Re-install left and right side panels.**
- 7. Re-install tool bag using stock mounting hardware.**
- 8. Check for function of license plate light, brake light, and turn signals and that all brackets and pieces are secure prior to riding.**