

# WOODCRAFT CFMOTORSPORTS

105 Baldwinville Rd  
Winchendon, MA 01475  
(978) 297-2977

## Ducati Diavel GP Rearset Instruction Sheet – Racing Use Only

Thank you for selecting CFMOTORSPORTS rearsets. The components you have just purchased for your motorcycle are designed to improve the ground clearance, crash worthiness and overall good looks of your motorcycle. Please note that these components are intended and approved for **racing use only**. As such, the footpegs are solid-mount and provisions for brake light switches and brake pedal return springs are generally not provided.

- 1) Remove stock rearsets, footpegs and associated hardware. All components that are re-used in this kit should be cleaned and inspected for damage before re-installation.

### IMPORTANT

Tighten all fasteners to factory specification or industry standard. FAILURE TO PROPERLY TIGHTEN ALL FASTENERS MAY CAUSE DAMAGE TO THE MOTORCYCLE, LOSS OF CONTROL AND SERIOUS INJURY OR DEATH

### Brake Side Assembly Installation

- 1) Prepare the main bracket (17) by bolting the pedal mount (16) and pedal stop (19) to the back side of the bracket with the included hardware. **IMPORTANT: Use Blue Loctite on all bolts**
- 2) Assemble the pedal shaft (3) & pivot (2) using LOCTITE on the bolts (6). The folding eccentric toe peg assembly is added in step #7. Bolt the pedal assembly to the pedal mount (16) using the OEM hardware (5) and o-rings (not shown). Be sure to apply waterproof grease on the sliding surface of the brake pedal.
- 3) Install the brake stop bolt (11) and free-flow nut (13) on the top of the brake pedal (2). The height of this bolt should be adjusted by bolting the finished assembly to the motorcycle and ensuring that the brakes do not drag when the pedal rests against the stop. The OEM brake light switch threads into the brake stop (#19). Attach the spring bolt (12) and free-flow nut (13) to the inside of the pedal. The spring (23) hooks on this bolt (12) and to the hole in part #19.

PART NUMBER	ITEM NO.	QTY
05-0670PMM	1	1
09-0670P	2	1
09-4145	3	1
06-4670	4	1
OEM Brake Bolt	5	1
04-FH620Z	6	2
04-FH1020Z	7	1
04-BH820 S/S	8	2
04-BH612 S/S	9	2
04-BH816Z	10	2
04-BH616 S/S	11	1
04-BH620 S/S	12	1
04-FN6RZ	13	2
05-0670FPB	14	1
OEM Pedal pin clip & spring	15	2
05-0670BPM	16	1
05-0670R	17	1
05-0670RSP	18	1
05-0670SAM	19	1
08-7899	20	1
04-FH612Z	21	1
04-FH614Z	22	1
09-SPR100E	23	1

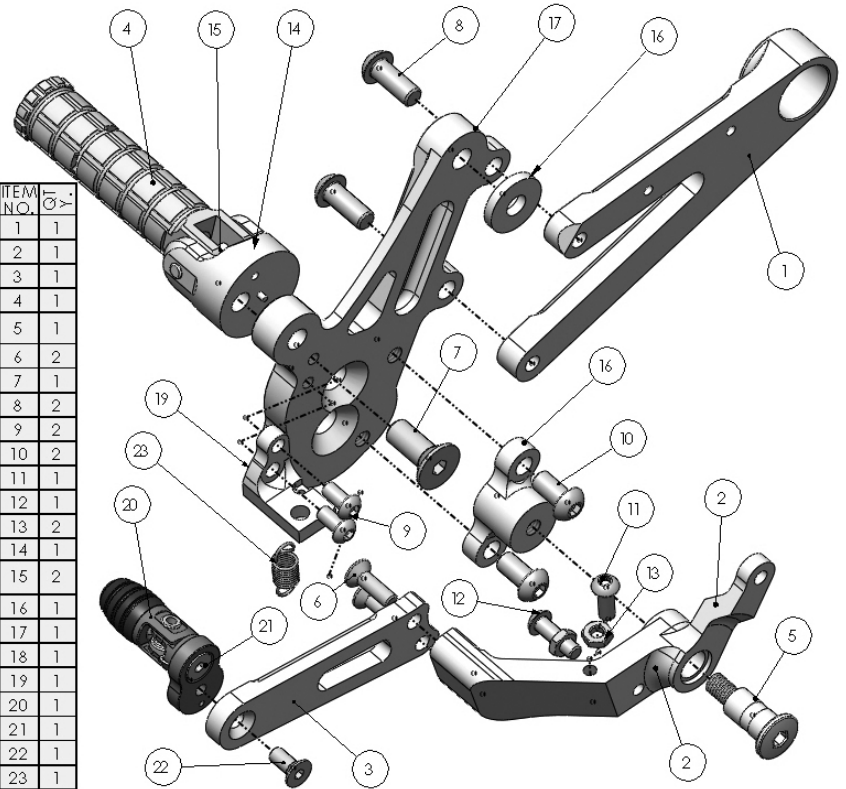

- 4) Attach the footpeg (4) to the footpeg mount (14) using the OEM pin, spring and cir-clip (not shown). NOTE: The peg can be installed in either direction so that it can fold up when the base is both in the forward or rear location. Bolt the CFM footpeg mount assembly to the bracket using the included 10mm hardware (7). Note that the footpeg has a 2-position eccentric height adjustment. The pegs on both sides of the motorcycle must be placed in the same location. **IMPORTANT –When mounted in the upper hole make sure to install the peg so it folds directly upwards. Secure mount bolt (7) with LOCTITE.** The extra holes are optional for riders using our solid (non-folding) toe peg.
- 5) Bolt the CFM pipe mount (1) to the main bracket using the 8mm bolts (8). The OEM hardware is used in the mount hole.
- 6) Bolt the brake bracket assembly to the frame using the OEM hardware. The spacer (18) goes behind the rearward hole.
- 7) Adjust the brake pedal to your desired height using the eccentric spacer (21). Assemble the eccentric folding toe peg (20) with (21) bolt. Attach the assembly to the shaft with (22) bolt. Be sure that the folding toe peg always bends straight back. **IMPORTANT: Use Blue Loctite on all bolts for the toe peg.**

**Shifter Side Assembly Installation**

ITEM NO.	PART NUMBER	QTY.
1	05-0670L	1
2	OEM Shift Bolt	1
3	OEM Footpeg Pin/Clip	1
4	OEM Spring	1
5	06-4670	1
6	05-0670FPB	1
7	04-FH1020Z	1
8	08-0671P	1
9	08-4145	1
10	04-FH620Z	2
11	08-7899	1
12	08-6MRH	1
13	04-LN6Z	1
14	04-BH620 S/S	1
15	04-FH614Z	1
16	07-2065	1

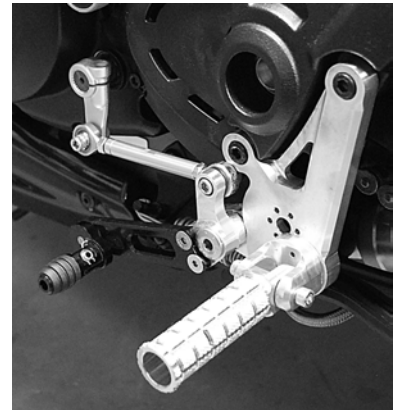
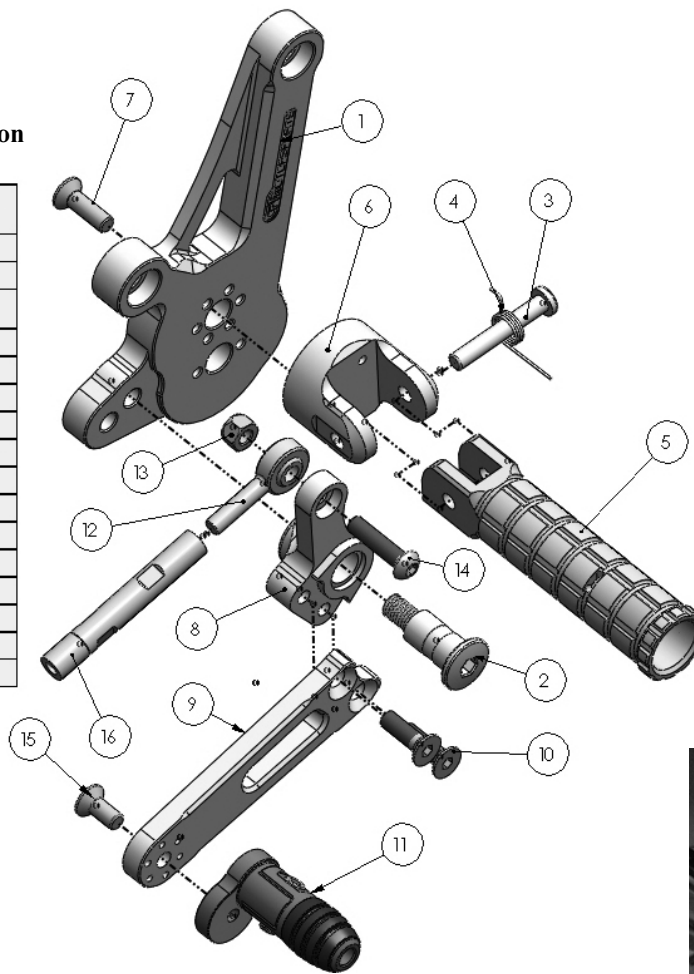

- 1) Assemble the pivot (8) & shaft (9) before installation using **LOCTITE** on bolts (10). The eccentric folding toe peg is added in step #6.
- 2) Bolt the pedal assembly to the bracket using the OEM shift bolt (2) and o-rings (not shown). If the peg mount (6) is oriented rearward use the rear hole; if the mount is oriented forward, use the front hole. Be sure to generously apply quality waterproof grease to the sliding surface of the footpeg to ensure smooth lever operation. **IMPORTANT - Secure the bolt (2) with LOCTITE.**
- 3) Attach the footpeg (5) to the footpeg mount (6) using the OEM pin (3), spring (4) and cir-clip (not shown). NOTE: The peg can be installed in either direction so that it can fold up when the base is both in the forward or rear location. Bolt the CFM footpeg mount assembly to the bracket using the included 10mm hardware. The footpeg has a 2-position eccentric height adjustment. The footpegs on both sides of the motorcycle must be placed in the same location. **IMPORTANT - When mounted in the upper hole make sure to install the peg so that it folds directly upwards. Secure mount bolt (7) with LOCTITE.** The extra holes are optional for riders using our solid (non-folding) toe peg.
- 4) Bolt the bracket assembly to the motorcycle using the OEM hardware.
- 5) Bring the pedal to the desired height using the shift rod (16) (using the OEM rod lock nuts). Once the pedal is adjusted to the desired height lock the rod in place with the OEM rod lock nuts. **IMPORTANT: Ensure the the rod is 90 degrees to the arm on the engine and the arm on the top of the shift pedal. See photo above.**
- 6) Assemble the eccentric folding toe peg (11) with bolt (17). Adjust the shift pedal to your desired height using the eccentric spacer. Attach the assembly to the pedal shaft with bolt (15). Be sure that the folding toe peg always bends straight back. **IMPORTANT: Use Blue Loctite on all bolts for the toe peg.**

**BE SURE THAT ALL COMPONENTS OPERATE AND RETURN FREELY BEFORE USE**  
 If you have any questions regarding installation, please feel free to contact us.

**IMPORTANT**

Installation and use of this product will change the response of the motorcycle to rider control inputs. Failure of the rider to adapt to these changes may result in a loss of control, and serious injury or death. Improper installation and/or failure to comply with all warnings and instructions may cause a loss of control and serious injury or death. **DO NOT INSTALL OR USE THIS PRODUCT IF YOU ARE UNABLE TO DO SO IN COMPLIANCE WITH ALL INSTRUCTIONS AND WARNINGS. SEEK THE ASSISTANCE OF A TRAINED PROFESSIONAL TECHNICIAN.** Installation of this product releases the Woodcraft Technologies, Inc. from all liabilities as to the use of this product. The user recognizes that any alteration or modification to any motorcycle may increase the risk of injury or accident and may also render the motorcycle illegal for public road use