

WOODCRAFT CFMOTORSPORTS

105 Baldwinville Rd
Winchendon, MA 01475
978-297-2977

Yamaha R6 2003-2005 Rearset Instruction Sheet – Racing Use Only

Thank you for selecting CFMOTORSPORTS rearsets. The components you have just purchased for your motorcycle are designed to improve the ground clearance, crash worthiness and overall good looks of your motorcycle. Please note that these components are intended and approved for **racing use only**. As such, the footpegs are solid-mount and provisions for brake light switches and brake pedal return springs are generally not provided.

Remove stock rearsets, footpegs and associated hardware. The entire kickstand bracket assembly can be removed for race use. All components that are re-used in this kit should be cleaned and inspected for damage before re-installation.

IMPORTANT

Tighten all fasteners to factory specification or industry standard. FAILURE TO PROPERLY TIGHTEN ALL FASTENERS MAY CAUSE DAMAGE TO THE MOTORCYCLE, LOSS OF CONTROL AND SERIOUS INJURY OR DEATH

Brake Side Assembly Installation

- 1) Attach the CFM master cylinder bracket to the backside of the right side rearset bracket using the included 6mm hardware. **IMPORTANT** -Secure the bolts with BLUE LOCTITE.
- 2) If you are using the CFM brake pedal, assemble the pedal with the included bolts. **IMPORTANT** -Secure the bolts with BLUE LOCTITE.
- 3) Bolt the CFM footpeg and the brake pedal (OEM or CFM) to the bracket using the included 10mm hardware. Be sure to generously apply quality waterproof grease to the sliding surface of the footpeg to ensure smooth lever operation. **IMPORTANT** - Secure the bolt with BLUE LOCTITE
- 4) Optional - The OEM heel guard may be attached to the back side of the bracket using the OEM bolts. There are two included 6mm washers that need to be placed between the guard and the bracket. **IMPORTANT** -Secure the bolts with BLUE LOCTITE.
- 5) Bolt the bracket to the frame and attach the master cylinder to the bracket using the OEM hardware. Re-connect the brake pedal to the master cylinder clevice using the OEM pin.
- 6) If you are using the OEM brake pedal the stock lever return spring may be attached to the lever and secured using the hook tab on the bottom of the bracket.

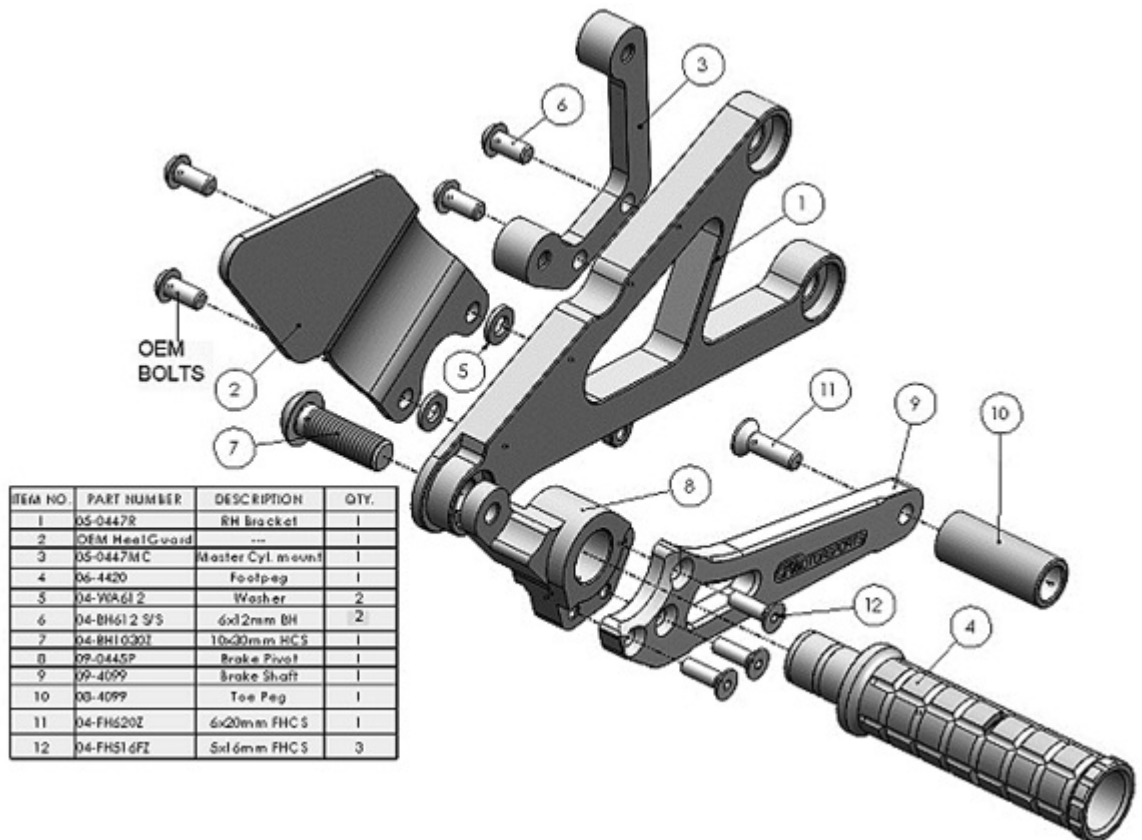

Shifter Side Assembly Installation

GP Shift Pattern

- 1) Remove the gear change actuator (the part connected to the motor) and flip it 180 degrees. The bend in the arm should be oriented so that the bend is to the outside of the motorcycle. Remove the heim joint and re-attach it so that it sits on the outside of the actuator. . **IMPORTANT** - Secure bolt with **BLUE LOCTITE**.
- 2) Bolt the CFM footpeg to the bracket using the included 10mm hardware. **IMPORTANT** - Secure bolt with **BLUE LOCTITE**. Bolt the CFM left bracket to the frame using the OEM hardware. The two large aluminum spacers are optional and can be placed between the bracket and the frame if needed to make the heel plate clear the swingarm.
- 3) With the footpeg and shift lever in hand, attach the shift rod simultaneously to the shift pedal and gear change actuator. The rod and actuator should be oriented so that they are approximately 90 degrees to each other. Rotate the rod until the desired pedal height is achieved. The rod should lie outside the frame. Lock the rod in place with the OEM nuts.
- 4) Bolt the shift pedal (OEM or CFM) to the bracket using the OEM hardware. Note that the OEM shim and wave washer are used as shown below. Be sure to generously apply quality waterproof grease to the sliding surface of the footpeg to ensure smooth lever operation. **IMPORTANT** – Secure bolt with **BLUE LOCTITE**

Standard Shift Pattern

- 1) Follow the above steps 2-4 above (skip step one) and route the shift rod through the center of the frame hole as is done with the stock assembly.

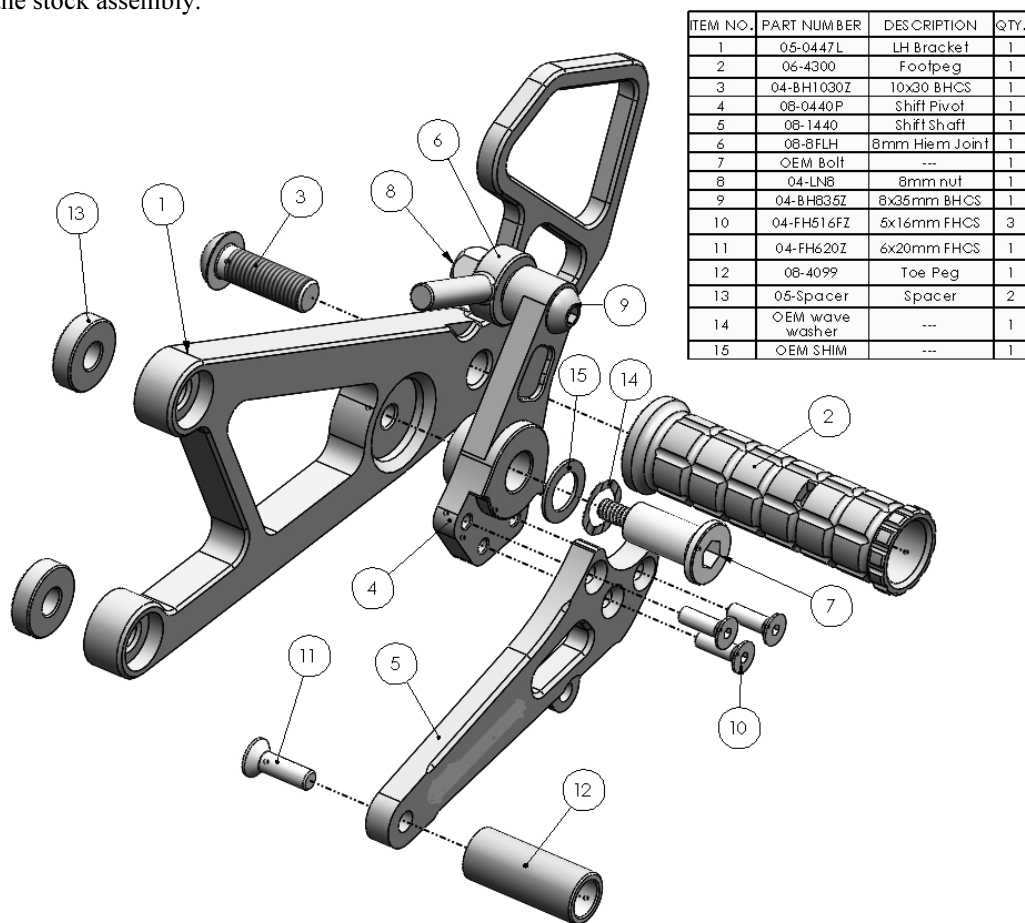

BE SURE THAT ALL COMPONENTS OPERATE AND RETURN FREELY BEFORE USE

If you have any questions regarding installation, please feel free to contact us.

IMPORTANT

Installation and use of this product will change the response of the motorcycle to rider control inputs. Failure of the rider to adapt to these changes may result in a loss of control, and serious injury or death. Improper installation and/or failure to comply with all warnings and instructions may cause a loss of control and serious injury or death. **DO NOT INSTALL OR USE THIS PRODUCT IF YOU ARE UNABLE TO DO SO IN COMPLIANCE WITH ALL INSTRUCTIONS AND WARNINGS. SEEK THE ASSISTANCE OF A TRAINED PROFESSIONAL TECHNICIAN.**