



Installation Instructions

60-0247LI Ignition Cover Instructions

1) Remove the OEM cover from the motor and unbolt the stator assembly. Clean all OEM bolts and clips for re-installation.

2) Attach the skid plate to the Woodcraft cover by bolting it from the inside. Each bolt should have an o-ring (supplied) on it before assembly. You can use a very small amount of grease on the o-ring to ease installation.

IMPORTANT - USE BLUE THREADLOCKING COMPOUND on the three skid plate mounting bolts. Completely coat the threads & allow time to cure before running!

3) Attach the pickup and wire retainer using the OEM hardware to the Woodcraft cover. Be sure that the retainer does not contact the rotor before assembly.

IMPORTANT - USE BLUE THREADLOCKING COMPOUND on all of the pickup / retainer mounting bolts and USE A QUALITY SILICONE SEALANT on both sides of the rubber plug for the stator wires (MANDATORY).

4) Completely clean the engine gasket surface. Install the Woodcraft cover with a new gasket using the OEM mounting hardware. Be very careful to pay close attention to the sequence of washers when re-installing the starter idle gear. This cover can use either the OEM or the Woodcraft start idle gear cover. A light coat of grease on the o-rings on the starter and the idle gear cover will ease installation.

5) Start the motorcycle and inspect for any leaks before riding.

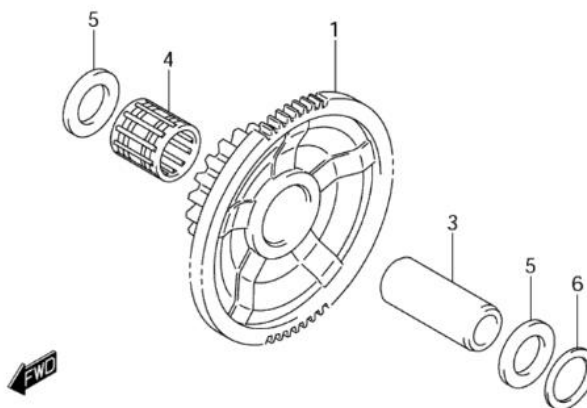

WARNING

Installation of Woodcraft Billet Covers involve removal and reinstallation of certain factory components such as fasteners, alternator stators and oil-retention gaskets. FAILURE TO INSTALL THESE COMPONENTS IN COMPLIANCE WITH ALL SPECIFIC INSTRUCTIONS SUPPLIED WITH BILLET COVER KIT, MAY CAUSE OIL LOSS OR DAMAGE TO ENGINE RESULTING IN LOSS OF CONTROL OF MOTORCYCLE AND SERIOUS INJURY OR DEATH.