

WOODCRAFT

Technologies, Inc.

Installation Instructions

60-0740R Clutch Cover Protector

ITEM NO.	PART NUMBER	DESCRIPTION	QTY.
1	60-0740RB	Cover	1
2	60-0740SP	Spacers	4
3	60-2500	Cover Pad (not shown)	1
4	60-0900	Skid Plate (SS or Alum)	1
5	04-FH510 S/S	5x10mm FHCS	3
6	04-BH645Z	6x45mm BHCS	3
7	04-BH655Z	6x55mm BHCS	1

1) Attach the skid plate to the Woodcraft cover by bolting it from the inside. The 60-2500 rubber pad should be adhered to the back side of the cover.

IMPORTANT - USE

THREADLOCKING COMPOUND ON THE THREE SKID PLATE MOUNTING BOLTS. Coat the threads completely and allow the threadlocking compound to fully set before use.

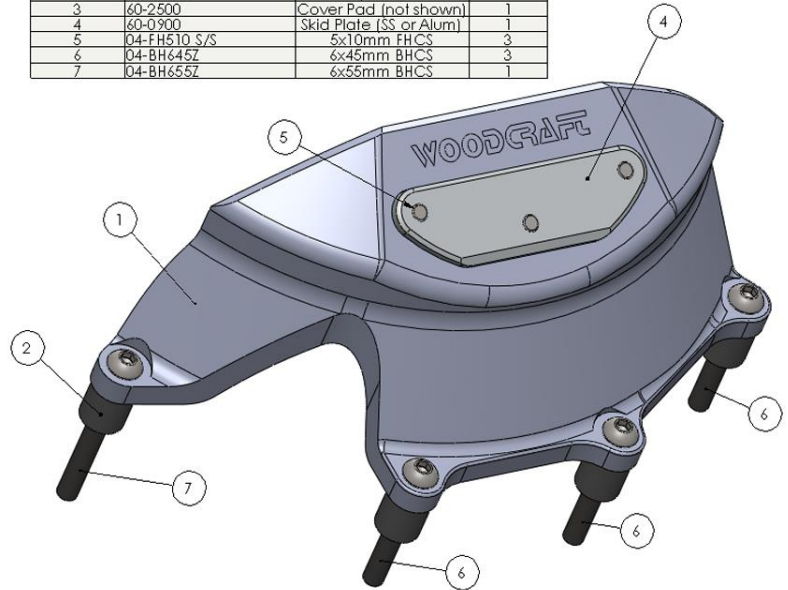

2) Install the Woodcraft cover with a using the included mounting hardware in the 4 locations shown at the right. The longest bolt is used in the hole furthest to the left when looking at the outside of the cover. Place the included spacers between the Woodcraft cover and the OEM cover. Torque for the mounting bolts is about 7 ft-lbs.

3) Start the motorcycle and inspect for any leaks before riding.

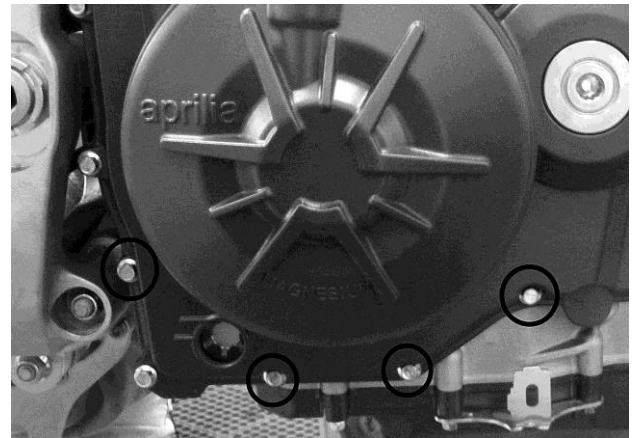

WARNING

Installation of Woodcraft Billet Covers involve removal and reinstallation of certain factory components such as fasteners, alternator stators and oil-retention gaskets. **FAILURE TO INSTALL THESE COMPONENTS IN COMPLIANCE WITH ALL SPECIFIC INSTRUCTIONS SUPPLIED WITH BILLET COVER KIT, MAY CAUSE OIL LOSS OR DAMAGE TO ENGINE RESULTING IN LOSS OF CONTROL OF MOTORCYCLE AND SERIOUS INJURY OR DEATH.**