

WOODCRAFT CFMOTORSPORTS

105 Baldwinville Rd
Winchendon, MA 01475
978-297-2977

Aprilia RSV Rearset Instruction Sheet – Racing Use Only

Thank you for selecting CFMOTORSPORTS rearsets. Please note that these components are intended and approved for **racing use only**. As such, the footpegs are solid-mount and provisions for brake light switches and brake pedal return springs are generally not provided. Remove stock rearsets, footpegs and associated hardware. The entire kickstand bracket assembly can be removed for race use. All OEM components that are re-used in this kit should be cleaned and inspected for damage before re-installation.

IMPORTANT

Tighten all fasteners to factory specification or industry standard. FAILURE TO PROPERLY TIGHTEN ALL FASTENERS MAY CAUSE DAMAGE TO THE MOTORCYCLE, LOSS OF CONTROL AND SERIOUS INJURY OR DEATH

Brake Side Bracket Installation

- 1) Bolt the CFM footpeg to the bracket using the included 10x30mm button head bolt.
IMPORTANT - Secure bolt with BLUE LOCTITE.
- 2) Attach the fairing mount bracket to the back side of the main rearset plate using the OEM hardware
- 3) Bolt the brake bracket assembly to the frame using the OEM hardware
- 4) Remove the OEM eccentric toe piece from the brake pedal and replace it with the extended CFM toe piece. Adjust the height to suit rider preference.

Shifter Side Bracket Installation

- 1) Bolt the CFM footpeg to the bracket using the included 10 x 30mm button head bolt.
IMPORTANT - Secure bolt with BLUE LOCTITE.
- 2) Attach the fairing mount bracket to the back side of the main rearset plate using the OEM hardware.
- 3) Bolt the shift bracket assembly to the frame using the OEM hardware.

Standard Shift

- 1) Remove the OEM toe piece from the shift pedal and replace it with the extended CFM toe piece. Adjust the height to suit rider preference.

GP Shift

- 1) Assemble the CFM shift pedal **with BLUE LOCTITE** tighten the heim joint on the top of the pedal.
- 2) Bolt the CFM shift pedal to the bracket using the supplied 8 mm bolt, wave washer and lever pivot spacer. (see Figure 1)
IMPORTANT - Secure bolt with BLUE LOCTITE.
- 3) Attach the CFM shift spline to the shift shaft of the motor (where the stock lever was) and orient it in roughly the vertical position.
- 4) Connect the CFM shift rod to the pedal and shift spline and adjust the pedal to the desired height. The rod should be 90 degrees to both the shift lever and the shift spline. Use the OEM lock nuts to secure the shift rod in place.

Figure 1 - GP Shift

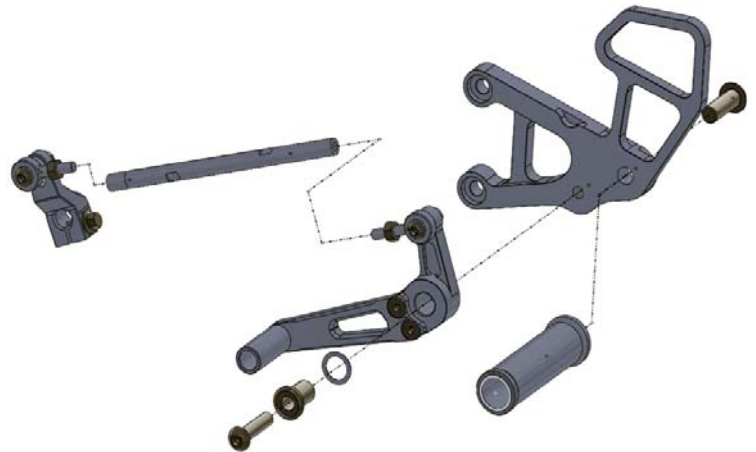

BE SURE THAT ALL COMPONENTS OPERATE AND RETURN FREELY BEFORE USE

If you have any questions regarding installation, please feel free to contact us.

IMPORTANT

Installation and use of this product will change the response of the motorcycle to rider control inputs. Failure of the rider to adapt to these changes may result in a loss of control, and serious injury or death. Improper installation and/or failure to comply with all warnings and instructions may cause a loss of control and serious injury or death. **DO NOT INSTALL OR USE THIS PRODUCT IF YOU ARE UNABLE TO DO SO IN COMPLIANCE WITH ALL INSTRUCTIONS AND WARNINGS. SEEK THE ASSISTANCE OF A TRAINED PROFESSIONAL TECHNICIAN.**