

# RS636K INSTRUCTIONS

TO BE INSTALLED BY A CERTIFIED MECHANIC ONLY | FOR RACE USE ONLY

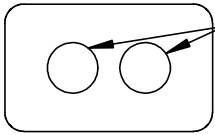

## How to adjust footpeg positions



1) Decide which mounting hole to use for base positioning.

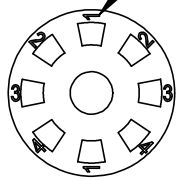

2) Position #1 at 12 o'clock for both shift side and brake side. Be sure other numbers are right-side-up.



3) Tab reader will indicate which position you are on.  
**CAUTION** - Each number has two positions. Be sure to coordinate positions for shift side and brake side.

Example

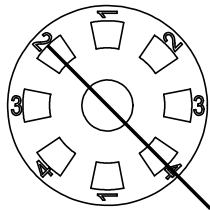

#2 Position

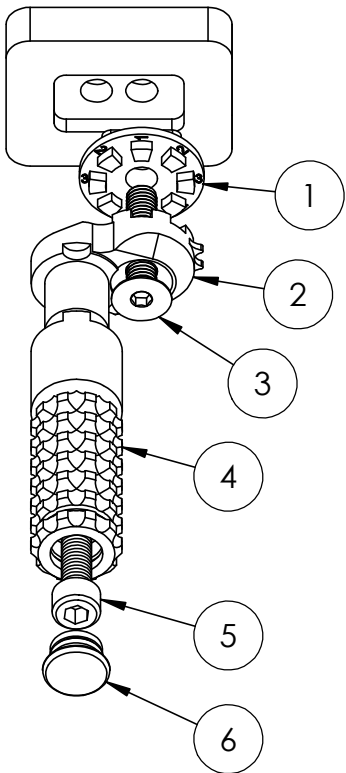
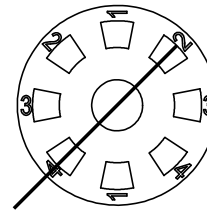

To make adjustments, first remove the end cap (6) and loosen bolt (5) so the footpeg (4) does not bind bolt (3). Loosen bolt (3) enough that bracket (2) is free to rotate around bracket (1). Set desired position and retighten everything.

Adjustment Positions (shift side example)

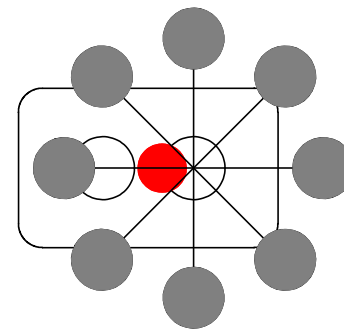
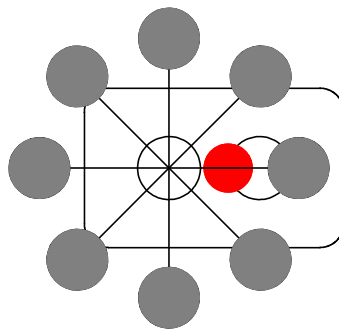

Adjustment Range:

Back	21mm
Forward	25mm
Up	17mm
Down	17mm

 OEM Footpeg position

