

RS275K INSTRUCTIONS

TO BE INSTALLED BY A CERTIFIED MECHANIC ONLY | FOR RACE USE ONLY

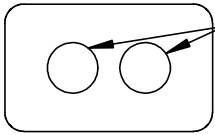

How to adjust footpeg positions



1) Decide which mounting hole to use for base positioning.

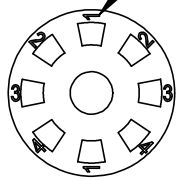

2) Position #1 at 12 o'clock for both shift side and brake side. Be sure other numbers are right-side-up.



3) Tab reader will indicate which position you are on.
CAUTION - Each number has two positions. Be sure to coordinate positions for shift side and brake side.

Example

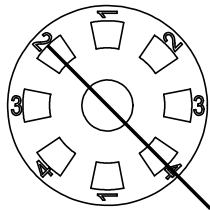

#2 Position

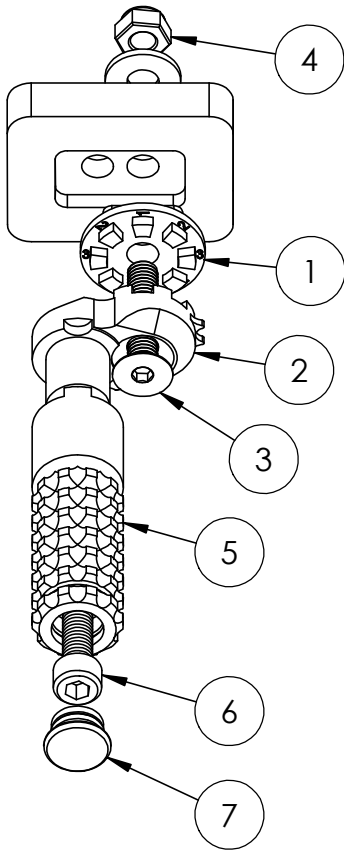
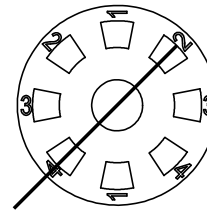

To make adjustments, first remove the end cap (7) and loosen bolt (6) so the footpeg (5) does not bind bolt (3). Loosen nut and bolt (4) & (3) enough that bracket (2) is free to rotate around bracket (1). Set desired position and retighten everything.

Adjustment Positions (shift side example)

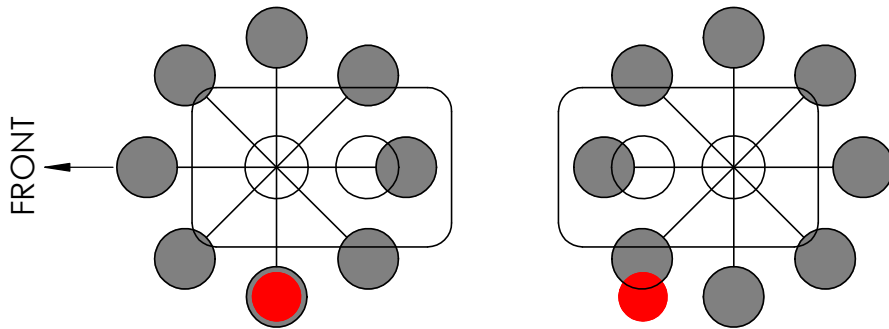

Adjustment Range: Back 29mm
Forward 17mm
Up 34mm
Down 0mm

OEM Footpeg position

