

!!! WARNING !!!

This is an aftermarket part built for racing purposes only.

Koso is not responsible for any damages caused to the parts, vehicle, or to yourself and others.

Engine parts are not under warranty nor is collateral damage or cost of labor, in cases of malfunction.



- Thank you for purchasing KOSO MSX Air cleaner box connecting tube.

INSTALLATION Picture expression

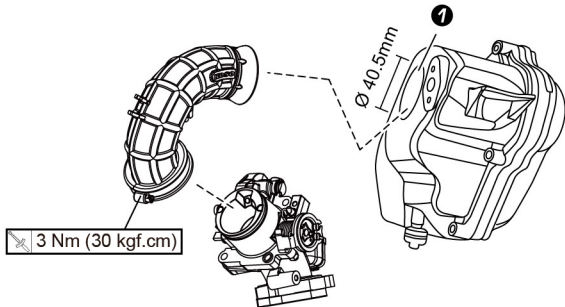

Please proceed as follows

1. Dis-assembly original air-cleaning, connect tube and throttle body from bike.
2. Do cleaning on air clean box and the connecting hole.
3. Enlarge connect tube hole to be $\text{Ø } 40.5\text{mm}$ (position ① on drawing).
4. Install KOSO air filter to your car filter.
5. Apply silica gel around the hose connector to keep it air tight and fixed to complete your installation work. °



NO SMOKING!

This suggests there is oil and inflammables in existence.
DO NOT smoke to prevent risks of fire.



INSTALLATION CAUTION!

Make sure all screws are tightened properly before starting the engine.



Denotes the tightening torque value.