

# WOODCRAFT CFMOTORSPORTS

105 Baldwinville Rd  
Winchendon, MA 01475  
978-297-2977

## Kawasaki Z125 Rearset Standard Shift Instruction Sheet – Racing Use Only

Thank you for selecting CFMOTORSPORTS rearsets. The components you have just purchased for your motorcycle are designed to improve the ground clearance, crash worthiness and overall good looks of your motorcycle. Please note that these components are intended and approved for **racing use only**. As such, the footpegs are solid-mount and provisions for brake light switches and brake pedal return springs are generally not provided.

Remove stock rearsets, footpegs, shift rod and associated hardware. Leave the master cylinder attached to the motorcycle. All components that are re-used in this kit should be cleaned and inspected for damage before re-installation.

### **IMPORTANT**

Tighten all fasteners to factory specification or industry standard. FAILURE TO PROPERLY TIGHTEN ALL FASTENERS MAY CAUSE DAMAGE TO THE MOTORCYCLE, LOSS OF CONTROL AND SERIOUS INJURY OR DEATH

### **Brake Side Assembly Installation**

- 1) Assemble the CFM brake pedal. Bolt the pivot (09-0107P), shaft (09-4145) and tip (08-4899) together with the included bolts. Leave the pedal tip finger tight at this point as you will likely adjust this position after testing footpeg positions. After selecting final position, secure this bolt with final torque. **IMPORTANT** -Secure all bolts with BLUE LOCTITE.
- 2) Bolt the CFM footpeg (06-4801) bracket using the included 10mm hardware. After testing the various positions and making your final selection - **IMPORTANT** – tighten the bolt and secure with BLUE LOCTITE.
- 3) Bolt the brake pedal to the back side of the bracket using the 04-BH620Z bolt and 05-0107BP pin. Be sure to apply a generous amount of waterproof grease on the outer surface of the pin. **IMPORTANT** - Secure the bolt with BLUE LOCTITE.
- 4) Connect the brake pedal to the master cylinder clevice using the OEM pin and clip.
- 5) Adjust the brake pedal to the desired height using a combination of the adjustable tip the OEM adjustment threads at the base of the master cylinder. Secure the bolt for the pedal tip with BLUE LOCTITE after tightening the bolt.
- 6) Secure the RH Bracket to the frame using the OEM hardware.

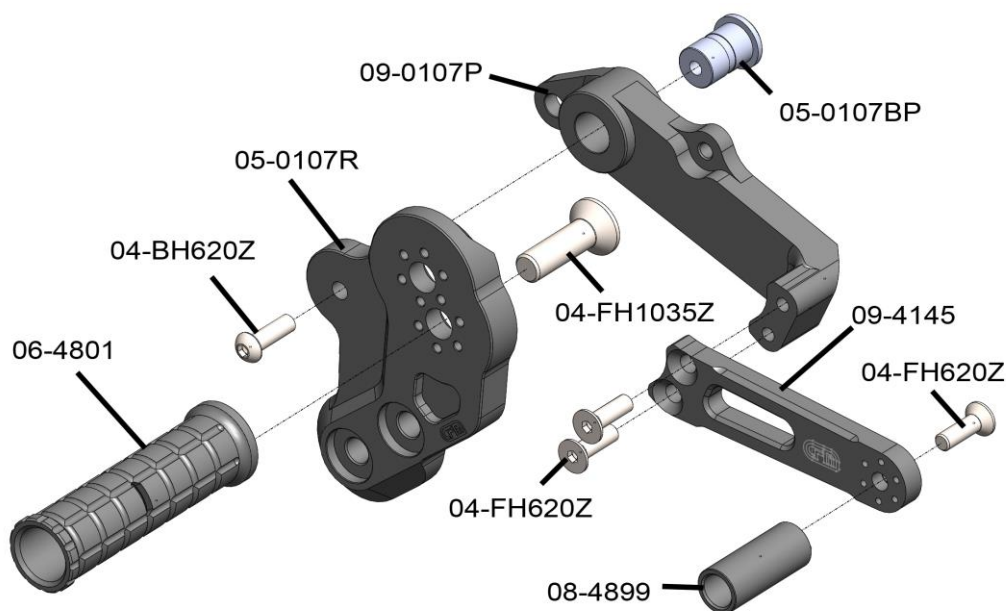

## Shift Side Assembly Installation

### Standard Shift Pattern

- 1) Orient OEM Shift Arm roughly as shown in the right-hand picture below.
- 2) Attach the Woodcraft hiem joint (08-6FLH) to the outside of the OEM Shift Arm using the supplied bolt (04-BH625Z) and lock nut (04-LN6).
- 3) Bolt the CFM footpeg (06-4801) to the bracket (05-0107L) using the included 10mm hardware in the same location that you used on the right side. **IMPORTANT** - Secure this bolt with BLUE LOCTITE after it is tightened. Bolt the CFM left bracket assembly to the frame using the OEM hardware.
- 4) Assemble the shift pivot (08-0107P) and shaft (08-4145) using the hardware indicated below. Attach the hiem joint (08-6FRH) to the pivot (08-0107P) using the 04-BH630Z bolt and 04-LN6Z lock nut. Secure this shift assembly to the bracket (05-0107L) using the OEM shift pivot bolt (be sure to coat the sliding surface of the bolt with a quality waterproof grease). **IMPORTANT** - Secure all bolts in this step with BLUE LOCTITE for final assembly.
- 5) Check to be sure that the 07-0235 rod has a jam nut threaded on both sides. Install the shift rod by simultaneously threading it into the two hiem joints. Ensure that the angles made between the shift rod, OEM Shift Arm and CFM shifter are roughly 90 degrees. Note the lines drawn on the RH photo below for reference. Adjust the length of the shift rod until you have reached a comfortable pedal height and the angles below are roughly 90 degrees. Lock the shift rod in place using the jam nuts.
- 6) Use the eccentric plate (08-7099E) to position the toe piece (08-4099) where it is most comfortable and then lock all the parts in place using the hardware indicated below. **IMPORTANT** – Secure the all bolts with BLUE LOCTITE

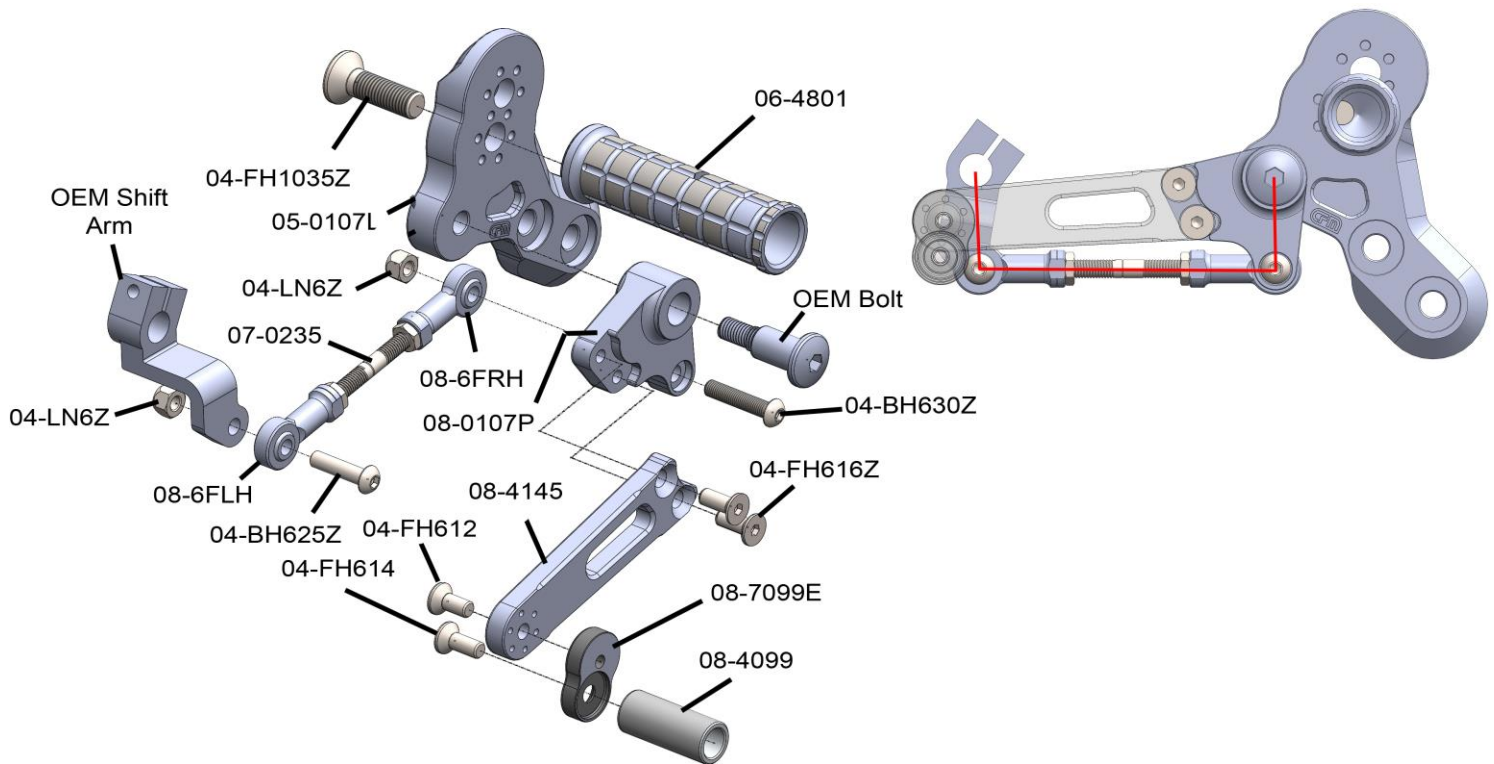

BE SURE THAT ALL COMPONENTS OPERATE AND RETURN FREELY BEFORE USE  
If you have any questions regarding installation, please feel free to contact us.

### **IMPORTANT**

Installation and use of this product will change the response of the motorcycle to rider control inputs. Failure of the rider to adapt to these changes may result in a loss of control, and serious injury or death. Improper installation and/or failure to comply with all warnings and instructions may cause a loss of control and serious injury or death. **DO NOT INSTALL OR USE THIS PRODUCT IF YOU ARE UNABLE TO DO SO IN COMPLIANCE WITH ALL INSTRUCTIONS AND WARNINGS. SEEK THE ASSISTANCE OF A TRAINED PROFESSIONAL TECHNICIAN.**