

**FOR OFF ROAD/RACE USE ONLY!**



**Driven 2015 YAMAHA R-3 REAR SET RELOCATION BRACKET**

**Part#: DRR-001**

**INSTALLATION INSTRUCTIONS**

### **Removal**

1. Remove OEM rear sets (both sides) retain M8 bolts.
2. Remove shift rod, don't remove shift knuckle.
3. Remove master cylinder reservoir, retain M6 bolt.

### **TOOLS REQUIRED**

- 10mm Open End Wrench
- 12mm Socket
- M6 Allen
- M4 Allen
- Blue Loctite
- Impact Gun

**THE USE OF BLUE LOCTITE IS REQUIRED ON ALL MOUNTING HARDWARE!**

### **Installation**

1. Install DRP-100315(right side) and DRP-100316(left side).
2. Install OEM rear sets into the desired position.
3. Connect supplied shift rod and adjust to reach desired lever height.
4. Connect reservoir bracket (DRP-100317).
5. Connect oem reservoir to bracket using oem bolt (adjust so hose is not kinked).
6. Torque all bolts to oem specs and use blue Loctite for all hardware.

***Make final adjustments as necessary and re-check all hardware after the first 300 miles of use.***

**THIS PRODUCT IS INTENDED TO BE INSTALLED BY A CERTIFIED TECHNICIAN\***

**FOR OFF ROAD/RACE USE ONLY!**



**Driven Rearset Relocation Brackets for 2015 Yamaha R3  
Part#: DRPR-001**

Relocation Brackets  
A00037

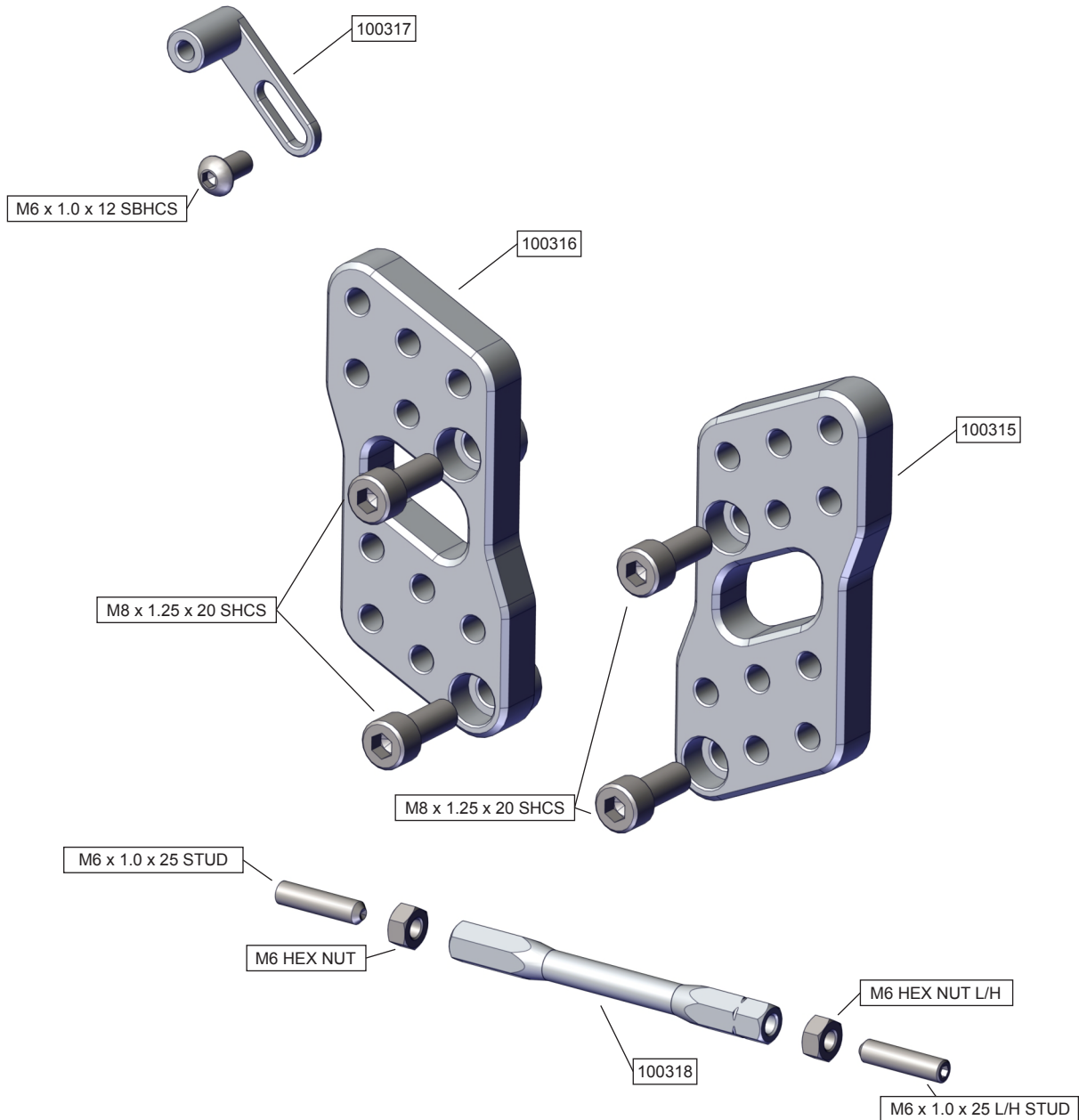

**THIS PRODUCT IS INTENDED TO BE INSTALLED BY A CERTIFIED TECHNICIAN\***