

FOR OFF ROAD/RACE USE ONLY!



Driven TT Rearsets for 2015 KTM RC 390

Part#: DRP-720

INSTALLATION INSTRUCTIONS

Removal

Shifter Side

1. Remove main bolt from rear set (**make sure swing arm is supported as the swing arm will fall if not supported**).
2. Remove lower bolts.
3. Remove kick stand.

Brake Side

1. Remove lower fairing.
2. Remove lower foot rest bolts.
3. Remove master cylinder from brake pedal and foot rest bracket.

TOOLS REQUIRED

- 8mm Open End Wrench
- 5mm Hex Key
- 6mm Hex Key
- 8mm Hex Key
- Needle Nose Pliers
- Screw Driver
- Blue Loctite
- Impact Gun

THE USE OF BLUE LOCTITE IS REQUIRED ON ALL MOUNTING HARDWARE!

Installation

NOTE: ALL PIVOT POINTS MUST BE TIGHTENED USING BLUE LOCTITE AND AN IMPACT GUN.

Shifter Side

1. Install kick stand onto frame bracket.
2. Install main bracket to bike using the long engine bolt (don't use adjusting nut and bolt).
3. Install bracket lower bolts (use OEM spacers and make sure chain glider is in place).
4. Install foot peg in rear set plate and mount into frame plate.
5. Reconnect shift rod into shift pedal.
6. Adjust lever to desired position.

For reverse shift connect shift rod to top screw.

Brake Side

1. Install frame bracket and torque to factory specs.
2. Install lower bolts, use Driven provided spacers and torque to factory specs.
3. Install master cylinder in rear set plate.
4. Connect brake clevis to the brake pedal using oem pin washer and split pin

TORQUE VALUES

- M5 = 6FT/LBS
- M6 = 10FT/LBS
- M8 = 25FT/LBS
- M10 = 45FT/LBS

Important note:

In order to get proper brake pedal alignment you will need to adjust the rear plunger pin.

Please make sure that once adjusted you have some free play in the pedal not having enough free play may cause rear brakes to lock.

5. Install foot peg into rear set plate and connect brake pedal to master cylinder using OEM pin and split pin
6. Connect rear set plate to frame bracket.
7. Reconnect lower fairing.
8. Use blue Loctite on all bolts and torque all to required specs.
- Zip tie loose brake line to the rear sets using a zip tie.
9. Make sure nothing interferes with proper operation of motorcycle.

Make final adjustments as necessary and re-check all hardware after the first 300 miles of use.

THIS PRODUCT IS INTENDED TO BE INSTALLED BY A CERTIFIED TECHNICIAN*

FOR OFF ROAD/RACE USE ONLY!



(Fig 1.) Brake

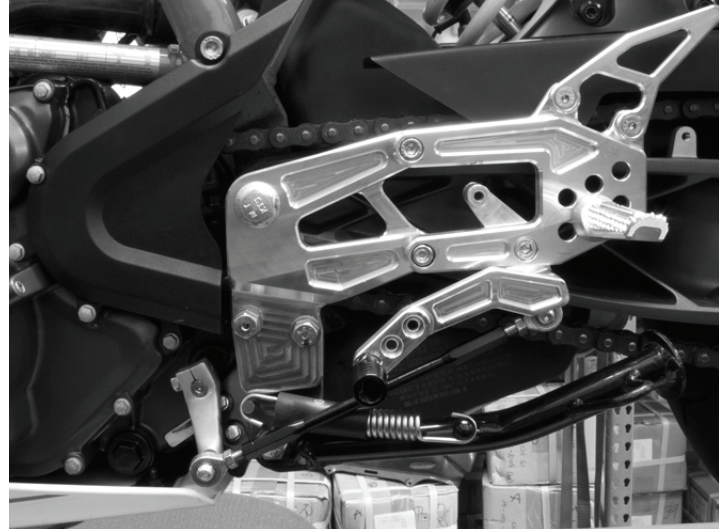

(Fig 2.) Standard Shift



(Fig 3.) Reverse Shift

NOTE: Pictures are of prototypes. Production version will vary.

THIS PRODUCT IS INTENDED TO BE INSTALLED BY A CERTIFIED TECHNICIAN*

FOR OFF ROAD/RACE USE ONLY!



Driven TT Rearsets for 2015 KTM RC 390

Part#: DRP-720

LEFT SIDE / SHIFTER
A00038

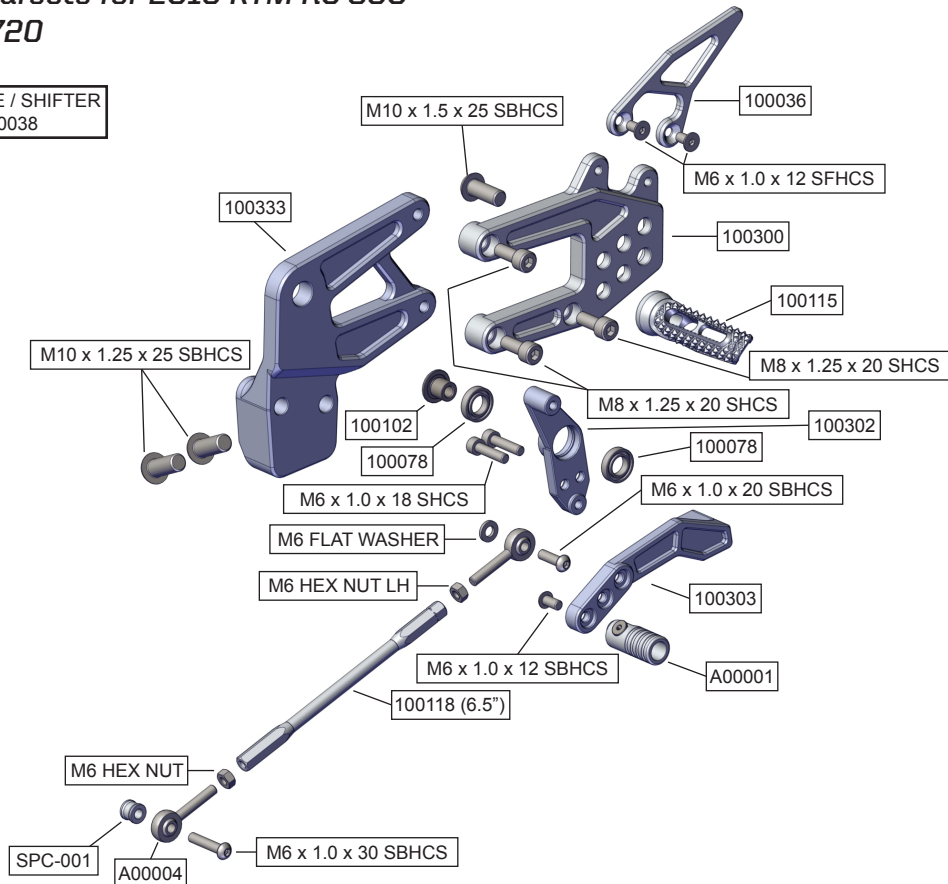

RIGHT SIDE / BRAKE
A00039

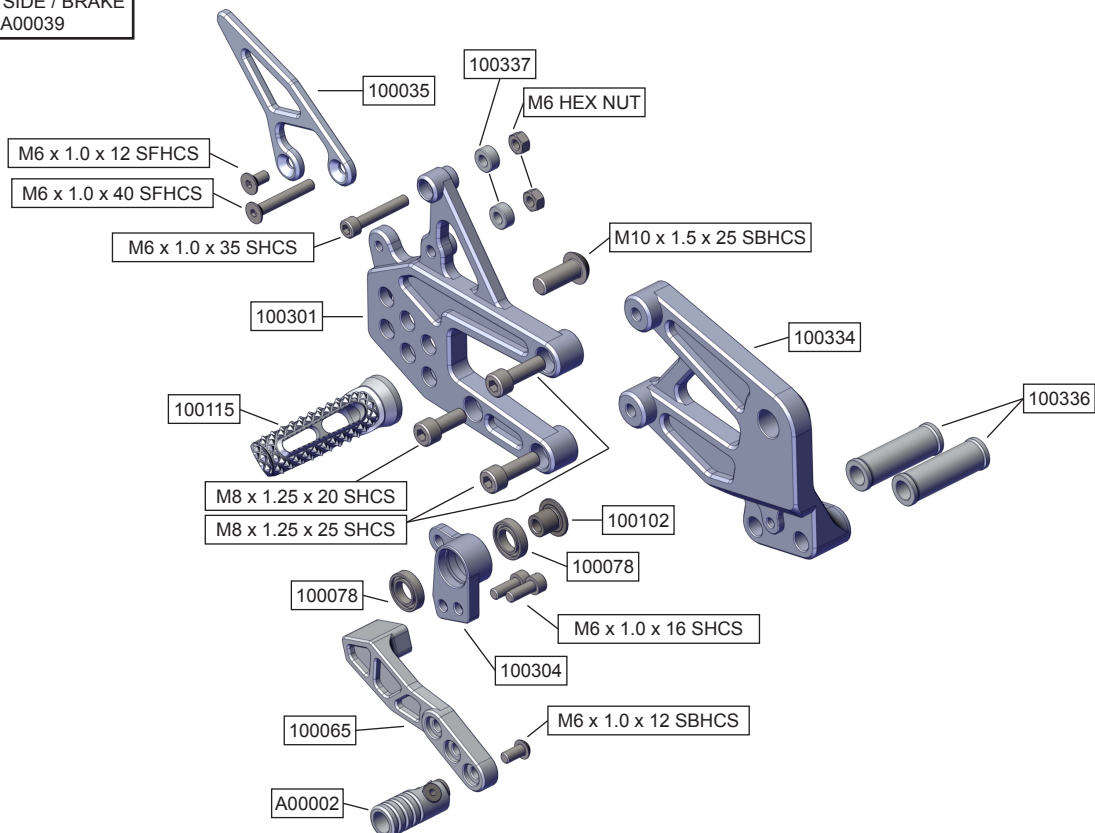

THIS PRODUCT IS INTENDED TO BE INSTALLED BY A CERTIFIED TECHNICIAN*