

**FOR OFF ROAD/RACE USE ONLY!**



**Driven TT Rearsets for 2017 Suzuki GSXR 1000/R**

**Part#: DRP-731**

## **INSTALLATION INSTRUCTIONS**

### **Removal**

#### **Shifter Side**

1. Remove shift rod from shifter.
2. Remove shift pedal from bike.
3. Remove 2 M8 bolts from frame bracket and remove plate from bike.

#### **Brake Side**

1. Remove 2 M6 bolts holding the master cylinder.
2. Remove master cylinder plunger pin and retain split pin.
3. Remove 2 M8 bolts and remove frame bracket.
4. Remove rear brake switch and disconnect it from bike.

### **TOOLS REQUIRED**

- 8mm Open End Wrench
- 5mm Hex Key
- 6mm Hex Key
- 8mm Hex Key
- Needle Nose Pliers
- Screw Driver
- Blue Loctite
- Impact Gun

**THE USE OF BLUE LOCTITE IS REQUIRED ON ALL MOUNTING HARDWARE!**

### **Installation**

NOTE: ALL PIVOT POINTS MUST BE TIGHTENED USING BLUE LOCTITE AND AN IMPACT GUN.

#### **Shifter Side**

1. Install new shift pedal.
2. Connect shift rod.
3. Install foot peg into left bracket.
4. Install frame bracket using M8 bolts.
5. Adjust shift pedal with shift rod for reverse shift simply rotate shift knuckle.

#### **Brake Side**

1. Install foot peg in frame bracket.
2. Connect master cylinder plunger to brake lever using oem cotter pin and pin.
3. Install frame bracket to bike.
4. Install master cylinder using 2 M6 bolts supplied.
5. Use blue Loctite on all bolts and torque all to required setting.
6. Make sure nothing interferes with proper operation of motorcycle.

### **TORQUE VALUES**

- M5 = 6FT/LBS
- M6 = 10FT/LBS
- M8 = 25FT/LBS
- M10 = 45FT/LBS

To connect the brake light switch to rear sets, use OEM switch and Driven supplied bracket. See Fig 3.

***Make final adjustments as necessary and re-check all hardware after the first 500 miles of use.***

**THIS PRODUCT IS INTENDED TO BE INSTALLED BY A CERTIFIED TECHNICIAN\***

**FOR OFF ROAD/RACE USE ONLY!**



(Fig 1.)

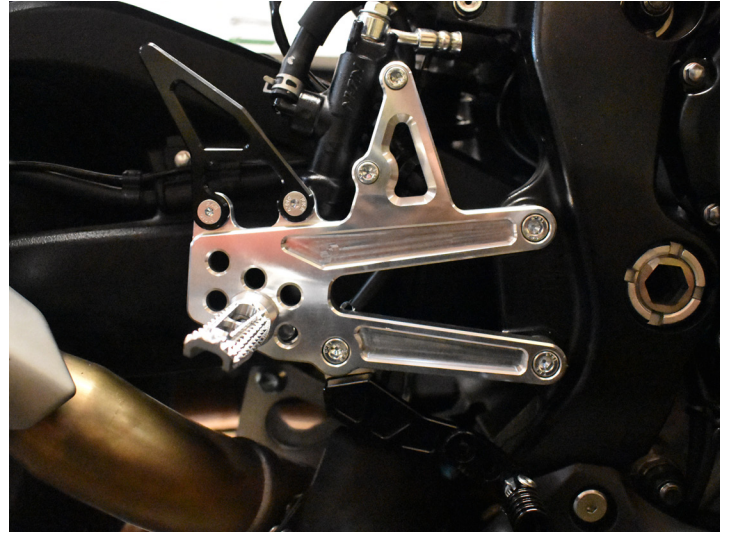

(Fig 2.)

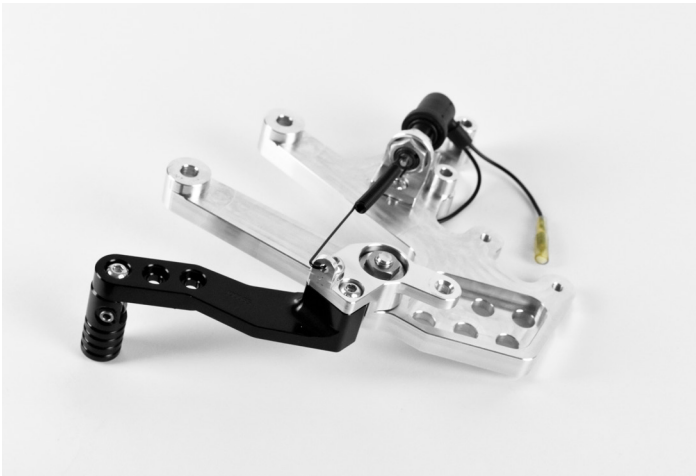

(Fig 3.)

**THIS PRODUCT IS INTENDED TO BE INSTALLED BY A CERTIFIED TECHNICIAN\***

**FOR OFF ROAD/RACE USE ONLY!**



Brake Side Assembly

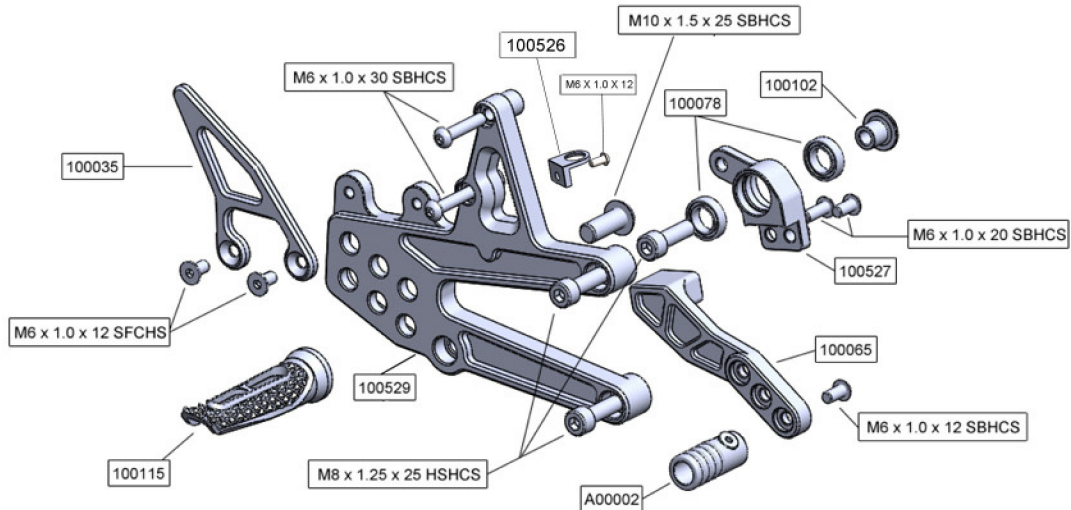

Shift Side Assembly

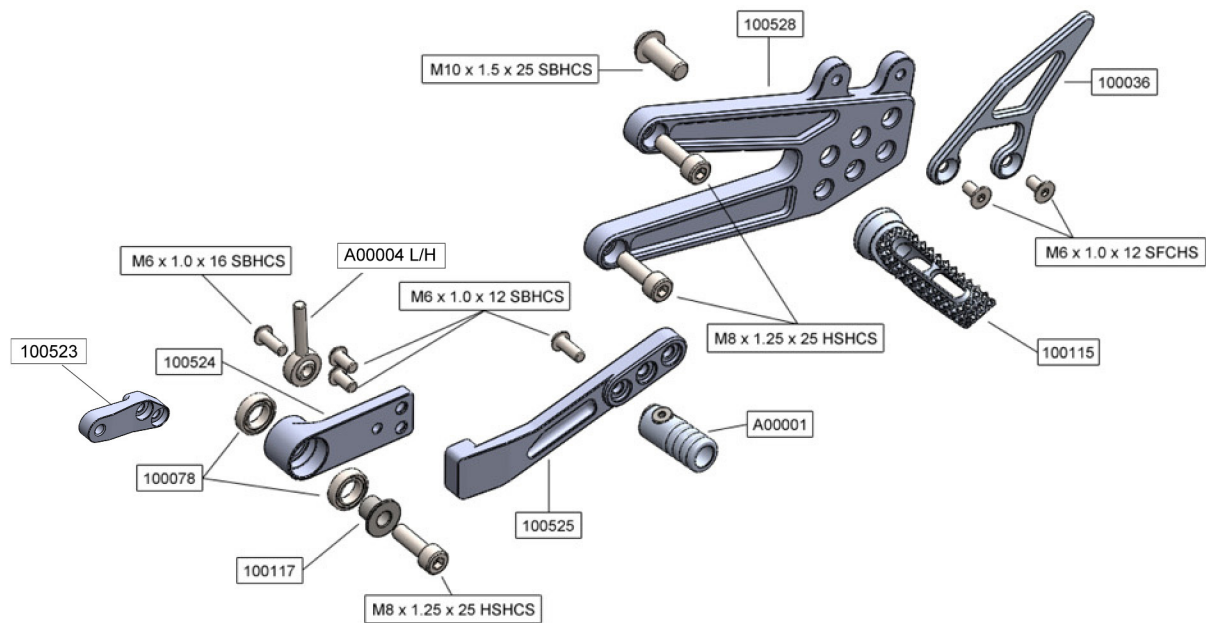

**THIS PRODUCT IS INTENDED TO BE INSTALLED BY A CERTIFIED TECHNICIAN\***