

**FOR OFF ROAD/RACE USE ONLY!**



*Driven TT Rearsets for 2016 Kawasaki Z125 PRO*

*Part#:DRP-724*

**INSTALLATION INSTRUCTIONS**

**Removal**

**Shifter Side**

1. Remove oem shift rod from bike (Leave shift arm in place)
2. Remove fame plate from bike

**Brake Side**

1. Remove foot peg plate from bike.
2. Remove master cylinder plunger pin and retain split pin.
3. Remove rear brake switch and return spring from bike.

**TOOLS REQUIRED**

- 8mm Open End Wrench
- 5mm Hex Key
- 6mm Hex Key
- 8mm Hex Key
- Neele Nose Pliers
- Screw Driver
- Blue Loctite
- Impact Gun

**THE USE OF BLUE LOCTITE IS REQUIRED ON ALL MOUNTING HARDWARE!**

**Installation**

**NOTE: ALL PIVOT POINTS MUST BE TIGHTENED USING BLUE LOCTITE AND AN IMPACT GUN.**

**Shifter Side**

1. Install foot peg in frame bracket
2. Install shift rod to shift arm using provided blt and nut.
3. Install frame bracket onto bike
4. Adjust shift lever with shift rod and tighten both safety nut.

**TORQUE VALUES**

- M5 = 6FT/LBS
- M6 = 10FT/LBS
- M8 = 25FT/LBS
- M10= 45FT/LBS

**Brake Side**

1. Connect master cylinder plunger to brake lever using oem cotter and split pin.
2. Install frame bracket to bike.
3. Make sure rear brake lever has free play.
4. Use blue Loctite on all bolts and torque all to required setting.
5. Make sure nothing interfere with proper operation of motorcycle.
6. Recheck all bolts after 500 miles of riding

**Make final adjustment as necessary and re-check all hardware after the first 500 miles of use.**

**THIS PRODUCT IS INTENDED TO BE INSTALLED BY A CERTIFIED TECHNICIAN\***

**FOR OFF ROAD/RACE USE ONLY!**



Driven TT Rearsets for 2016 Kawasaki Z125 PRO  
Part#:DRP-724

### Brake Side

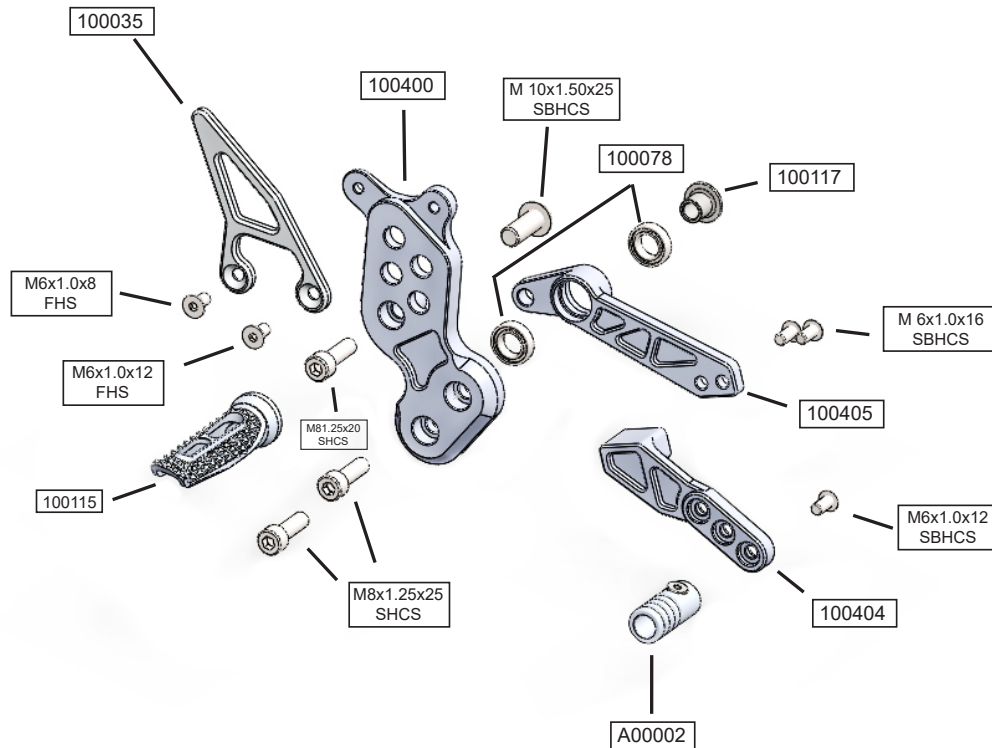

### Shifter Side

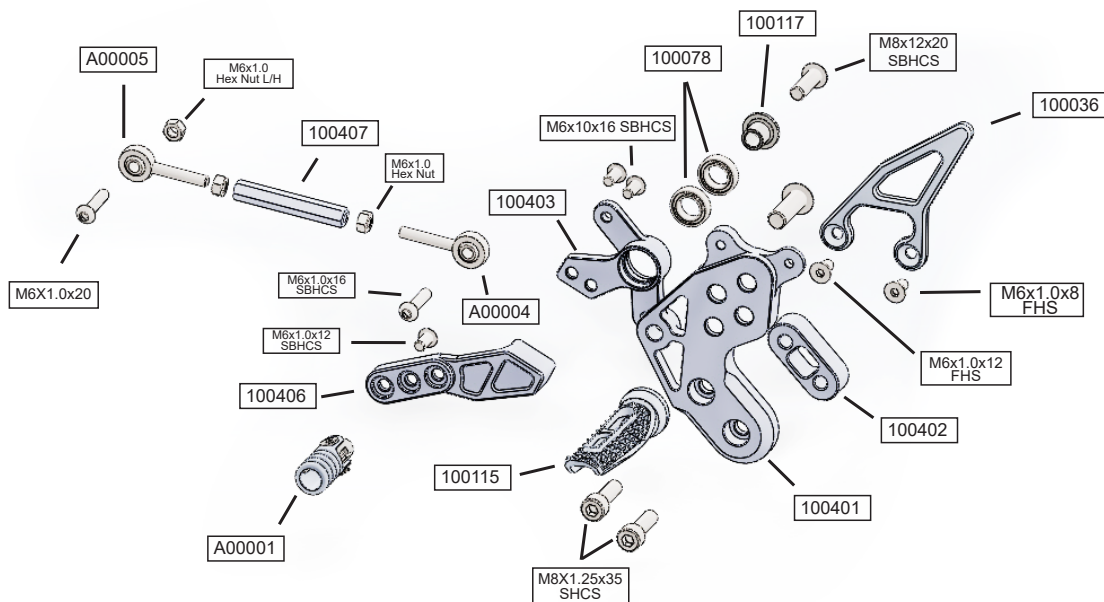

**THIS PRODUCT IS INTENDED TO BE INSTALLED BY A CERTIFIED TECHNICIAN\***

**FOR OFF ROAD/RACE USE ONLY!**

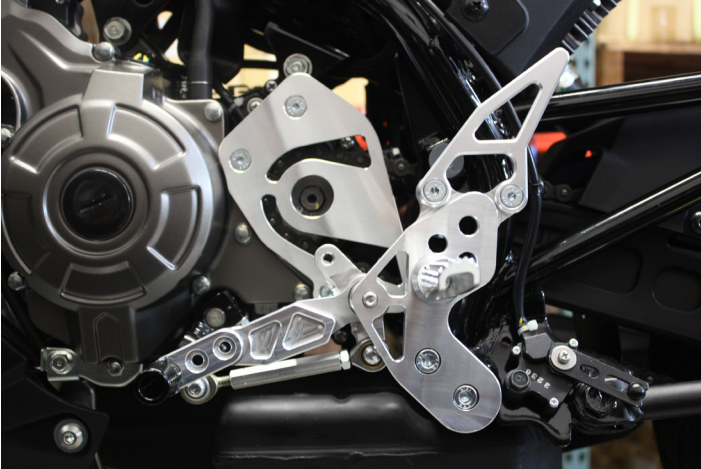

STANDARD SHIFT



BRAKE SIDE

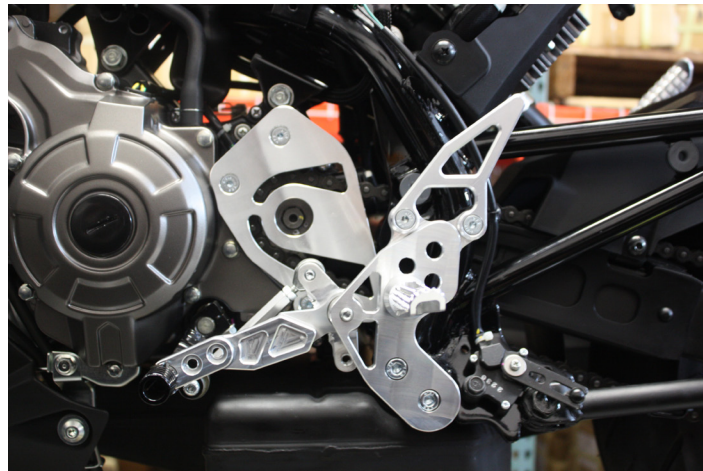

REVERSE SHIFT

**THIS PRODUCT IS INTENDED TO BE INSTALLED BY A CERTIFIED TECHNICIAN\***