

**FOR OFF ROAD/RACE USE ONLY!**



**Driven TT Rearsets for Yamaha R-1 09-14**

**Part#: DRP-711**

**INSTALLATION INSTRUCTIONS**

**Removal**

1. Remove left side (shifter side) frame bracket.
2. Remove shift lever.
3. On the right side (brake side) remove exhaust hanger bolt.
4. Remove right side frame bracket.
5. Remove master cylinder plunger pin (save the cotter pin).
6. Remove master cylinder from frame bracket.

**THE USE OF BLUE LOCTITE IS REQUIRED ON ALL MOUNTING HARDWARE!**

**Installation**

**Brake Side**

1. Install master cylinder into left frame bracket.
2. Install master cylinder plunger pin and reuse cotter pin.
3. Install frame bracket to bike.
4. Tighten all bolts (using blue Loctite).
5. When not using the passenger footpeg to mount rear master cylinder reservoir, use part #100203 and M6 Bolt supplied.

**TOOLS REQUIRED**

- 8mm Open End Wrench
- 5mm Hex Key
- 6mm Hex Key
- 8mm Hex Key
- Needle Nose Pliers
- Screw Driver
- Blue Loctite
- Impact Gun

**Shifter Side**

1. Install left side foot peg into frame bracket.
2. Install frame bracket assembly onto bike.
3. Install shift pedal and thread shift rod into both heim joints (left and right).
4. Adjust pedal height to desired position by rotating shift rod.
5. Tighten all bolts and nuts (use blue Loctite).

**Note. If "gp shift pattern" is desired rotate shift knuckle 180 degrees.**

**Make final adjustments as necessary and re-check all hardware after the first 500 miles of use.**

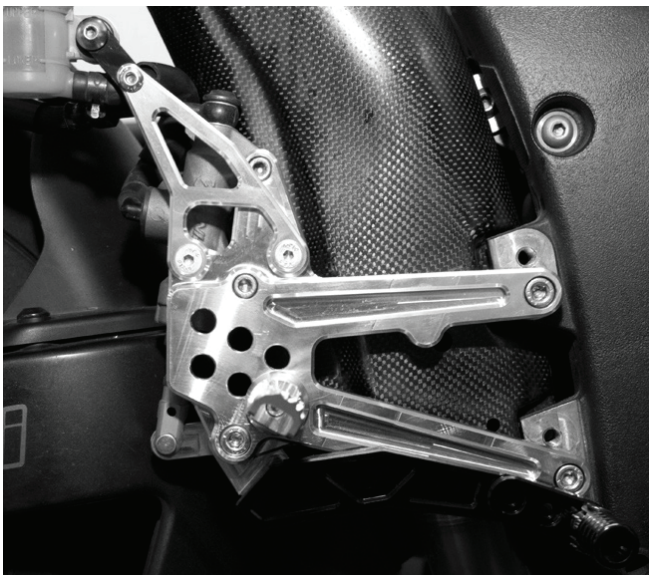

Brake Side

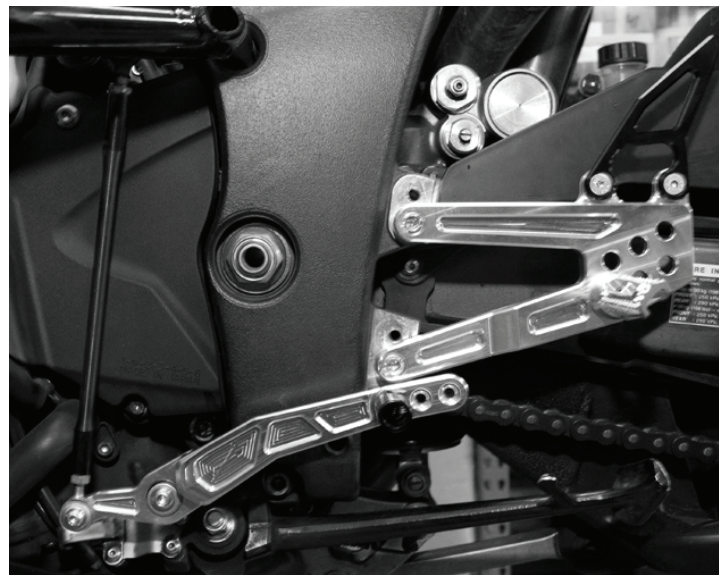

Shifter Side

**THIS PRODUCT IS INTENDED TO BE INSTALLED BY A CERTIFIED TECHNICIAN\***

**FOR OFF ROAD/RACE USE ONLY!**



Driven TT Rearsets for 09-14 Yamaha R-1

Part#: **DRP-711**

LEFT SIDE / SHIFTER  
A00020

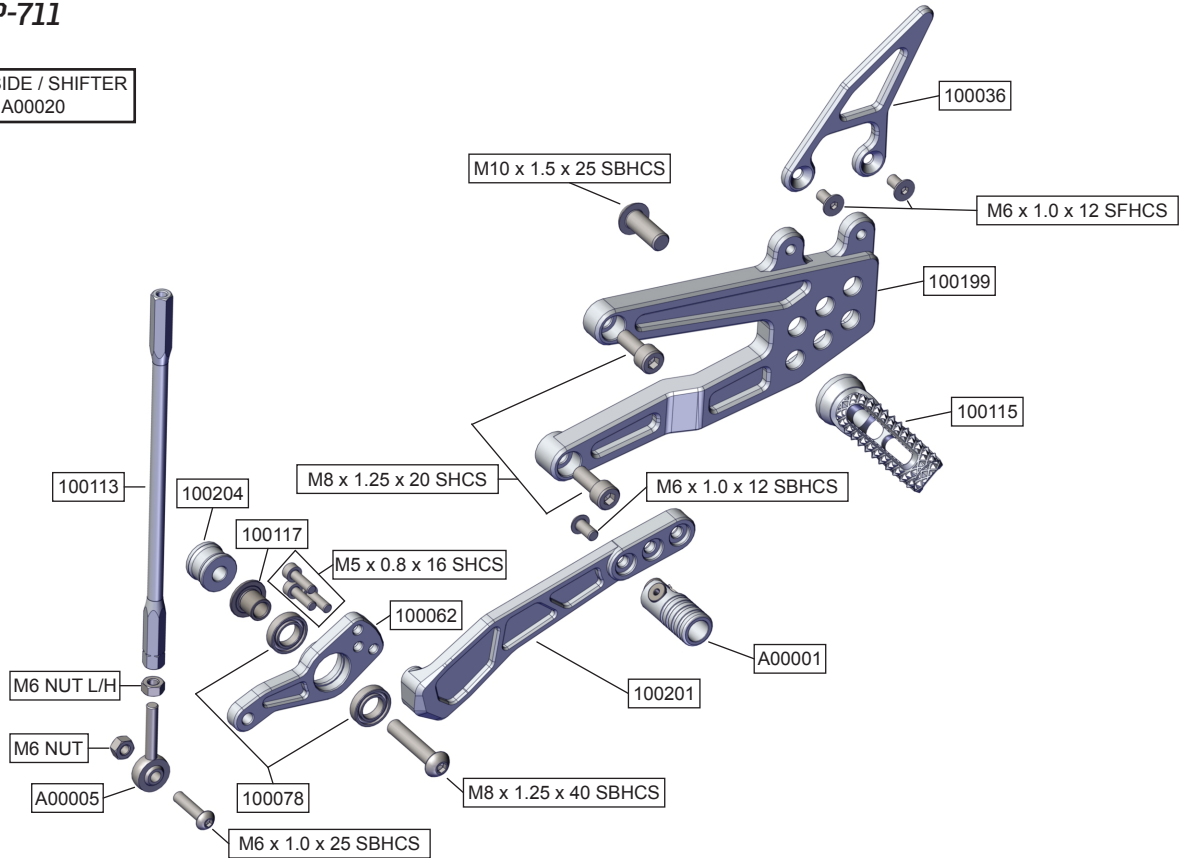

RIGHT SIDE / BRAKE  
A00021

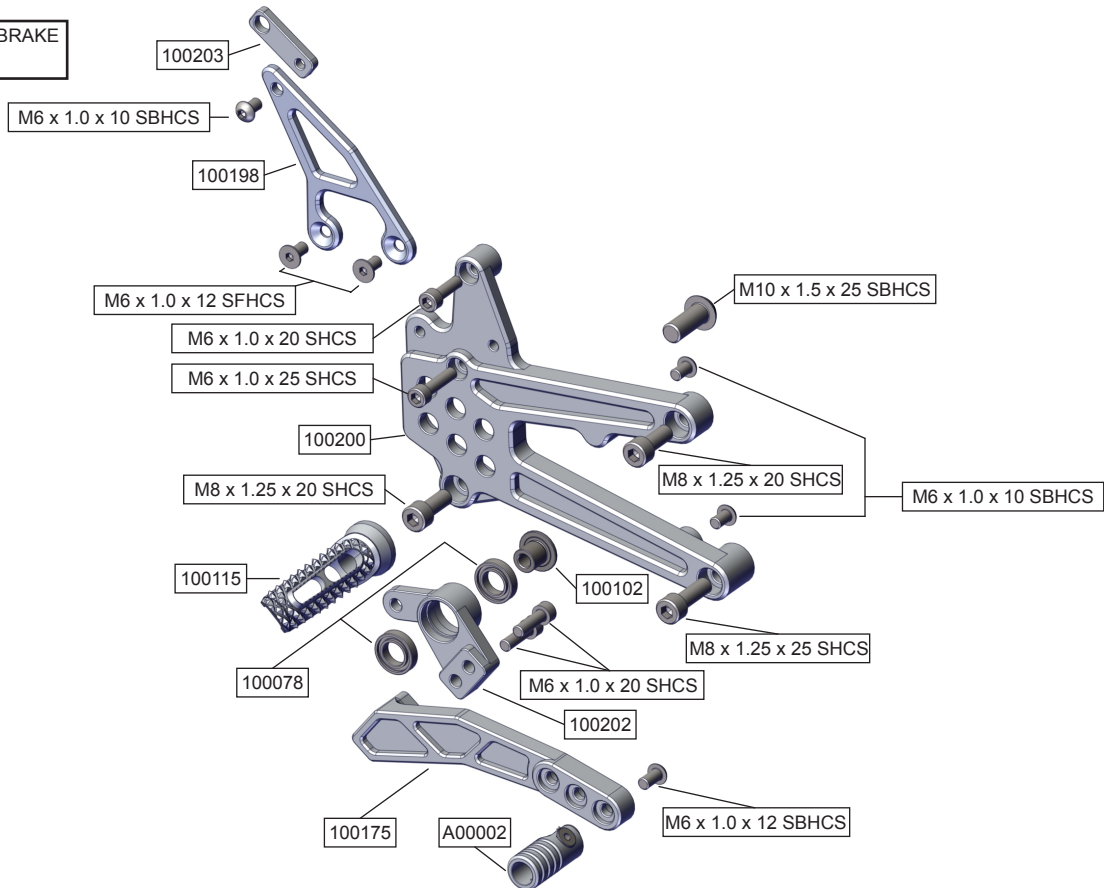

**THIS PRODUCT IS INTENDED TO BE INSTALLED BY A CERTIFIED TECHNICIAN\***