

**FOR OFF ROAD/RACE USE ONLY!**



**Driven TT Rearsets for 2015 Yamaha FZ-07**

**Part#: DRP-709**

## **INSTALLATION INSTRUCTIONS**

### **Removal**

#### **Shifter Side**

1. Remove shift shaft from shift knuckle. (see Fig 2.)
2. Remove 2 M8 bolts holding rear set plate and remove from bike.

#### **Brake Side**

1. Remove 2 M8 bolts holding the heel guard.
2. Remove 2 M8 bolts holding rear set and remove from bike.
3. Remove master cylinder plunger pin and retain split pin.
4. Remove rear brake switch and disconnect it from bike.

**THE USE OF BLUE LOCTITE IS REQUIRED ON ALL MOUNTING HARDWARE!**

### **Installation**

#### **Shifter Side**

1. Rotate shift knuckle to 8 o'clock position.
2. Connect heim joint to shift knuckle. (see Fig 2.)
3. Install foot peg in desired position.
4. Install frame bracket and connect shift rod to shift knuckle, adjust to desired height.

#### **Brake Side**

1. Install foot peg in frame bracket.
2. Connect master cylinder plunger to brake lever using oem cotter pin and pin.
3. Install frame bracket to bike.
4. Install master cylinder using 2 m8 bolts supplied.
5. Use blue Loctite on all bolts and torque all to required setting.
6. Make sure nothing interferes with proper operation of motorcycle.

#### **TOOLS REQUIRED**

- 8mm Open End Wrench
- 5mm Hex Key
- 6mm Hex Key
- 8mm Hex Key
- Needle Nose Pliers
- Screw Driver
- Blue Loctite
- Impact Gun

**Make final adjustments as necessary and re-check all hardware after the first 500 miles of use.**



(Fig 1.)

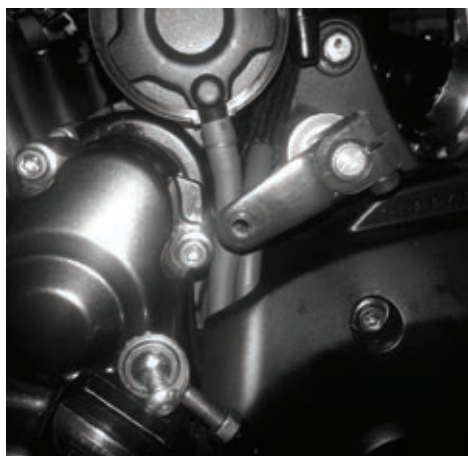

(Fig 2.) Shifter Close up

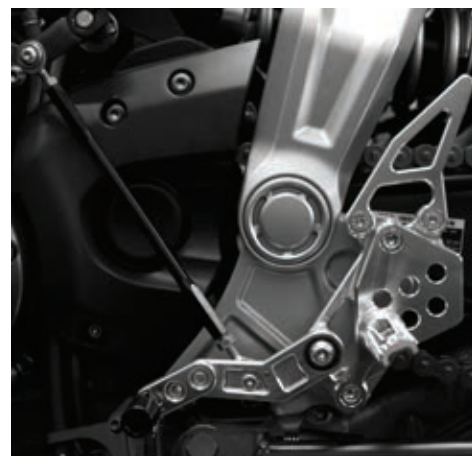

(Fig 3.)

**THIS PRODUCT IS INTENDED TO BE INSTALLED BY A CERTIFIED TECHNICIAN\***

**FOR OFF ROAD/RACE USE ONLY!**



**Driven TT Rearsets for 2015 YAMAHA FZ 07**

**Part#: DRP-709**

**LEFT SIDE / SHIFTER  
A00016**

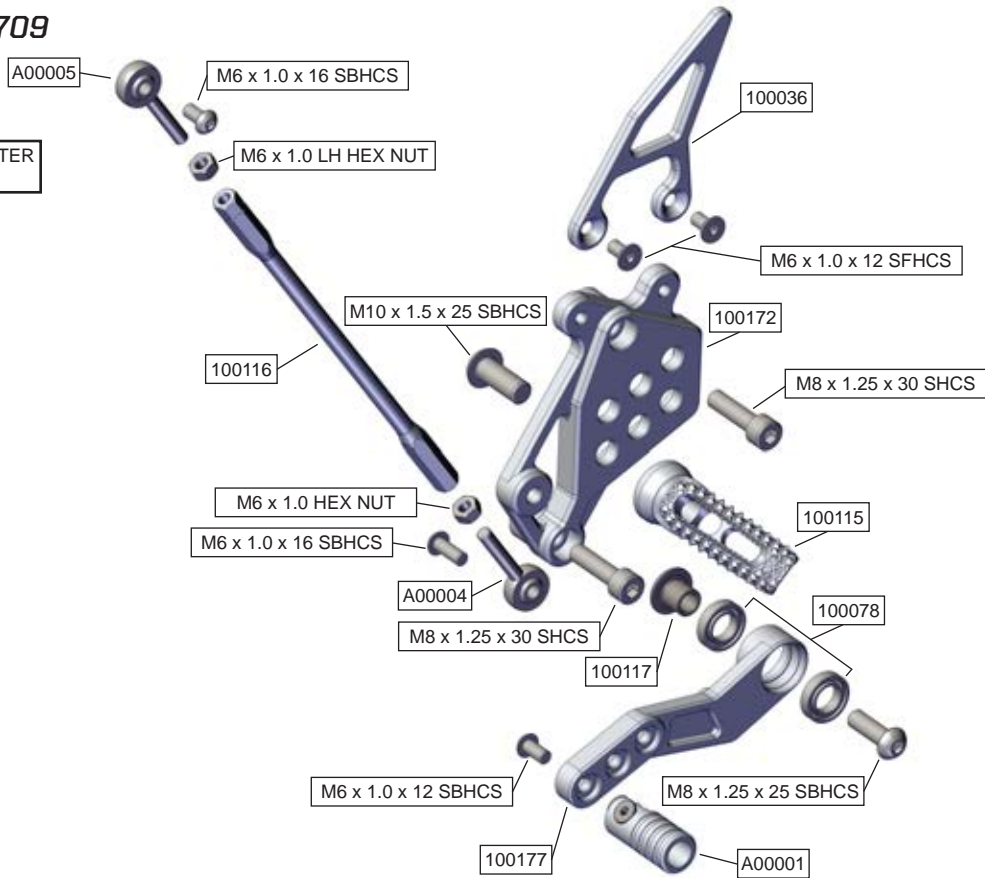

**RIGHT SIDE / BRAKE  
A00017**

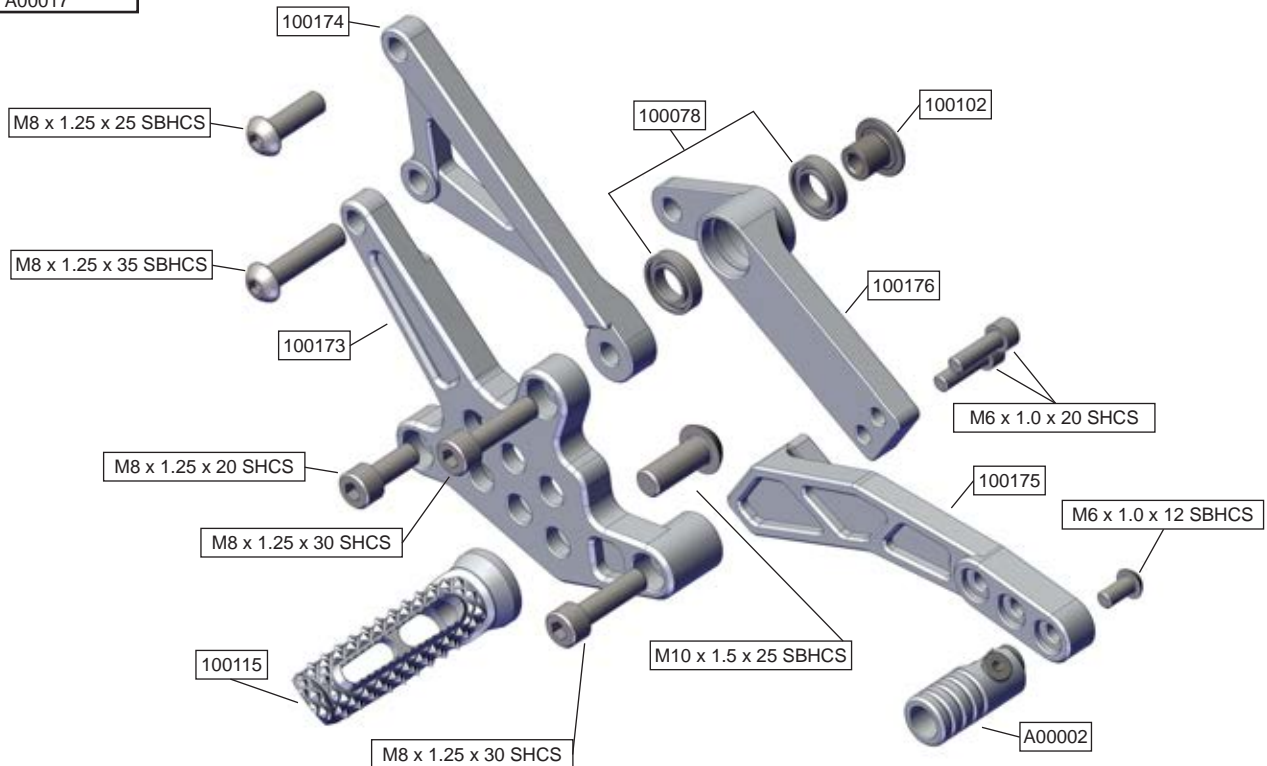

**THIS PRODUCT IS INTENDED TO BE INSTALLED BY A CERTIFIED TECHNICIAN\***