

Yamaha YZF R1 2015

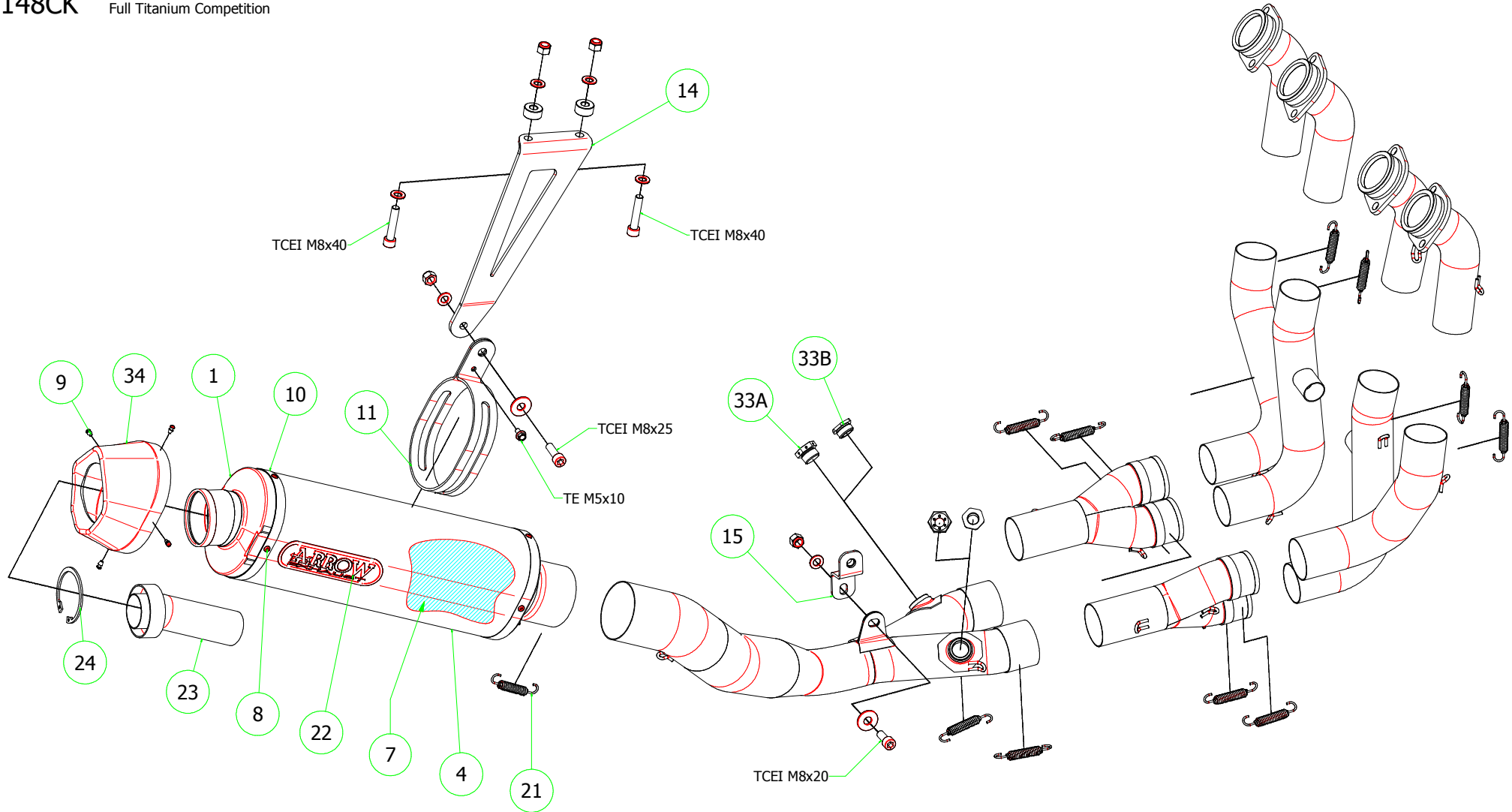

- 71147CKZ Full System Competition
- 71148CKZ Full Titanium Competition
- 71147CK Full System Competition
- 71148CK Full Titanium Competition



PARTI DI RICAMBIO / SPARE PARTS

ID	DESCRIZIONE / DESCRIPTION	71147CK cod	71148CK cod	71147CKZ cod	71148CKZ cod
1	Fondello Posteriore / End Cap	5009975	5009975	5009972	5009972
2	Fondello Posteriore Dx - Lat. / Right-lateral end cap				
3	Fondello Posteriore Sx-Sup. / Left-upper end cap				
4	Corpo Marmitta / Silencer Sleeve	5260371	5260371	5260371	5260371
5	Corpo Marmitta "dx" / Right Silencer Sleeve				
6	Corpo Marmitta "sx" / Left Silencer Sleeve				
7	Materiale fonoassorbente / Sound-absorbant material	5690057	5690057	5690165	5690165
8	Rivetto inox mm 4.8 / Stainless Steel 4.8 mm Rivet	3608011	3608011	3608011	3608011
9	Rivetto allum.mm.3.0 nero / Black Aluminium 3.0 mm Rivet	3608010	3608010	3608010	3608010
10	Fascetta di Serraggio / Strap For Rivets	5495085	5495085	5495085	5495085
11	Fascetta di Sostegno / Silencer Clamp	5490034	5490034	5490034	5490034
12	Guarnizione x Fascetta / Clamp Gasket				
13	Copri Fascetta / Stainless Steel Clamp Protection				
14	Staffa / Bracket	5846297	5846297	5846297	5846297
15	Staffa sostegno "Dx" / Right Bracket	5833095	5833095	5833095	5833095
16	Staffa sostegno "Sx" / Left Bracket				
17	Inserto Rapid Nut / Rapid nut insert				
18	Molla lunga gangio tondo / Long Spring With Round Hook				
19	Molla lunga gancio ad "U" / Long Spring With "U" Hook				
20	Molla corta gancio tondo / Short spring with roud hook				
21	Molla corta gancio ad "U" / Short Spring With "U" Hook	3416020	3416020	3416020	3416020
22	Targhetta Arrow / Arrow Plate				
23	Silenziatore Interno / Db Killer			5930242	5930242
24	Seeger / Retain Clip			3640048	3640048
25	Fascetta Stringitubo / Pipe Clamp				
26	Boccola / Bushing				
27	Flangia / Flange				
28	Protezione / Heat Shield				
29	Protezione Dx / Right heat shield				
30	Protezione Sx / Left heat shield				
31	Gommino Battuta Cavalletto / Rubber Kickstand Protection				
32	Guarnizione di tenuta / Gasket				
33A	Tappo Sonda Lambda / Lambda Sensor Plug Bolt	5175001	5175001	5175001	5175001
33B	Riduzione sonda lambda / Lambda Sensor Boss	5175012	5175012	5175012	5175012
34	Fondello carby / Carby cap	5704139	5704139	5704139	5704139