

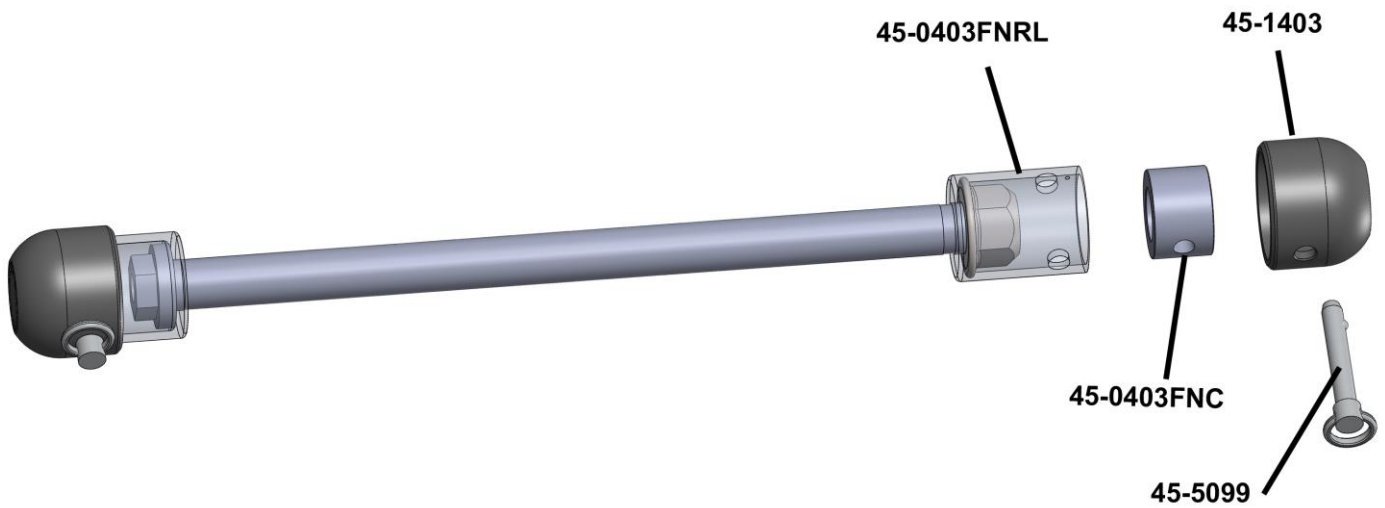

45-0433F Yamaha '15 -17 R3
Installation Instructions
Front Axle Slider Kit

- 1) Remove the front axle.
- 2) Take one of the 45-0403FNRL aluminum parts and slide it over the axle so that the hex head of the axle sits in the bottom of the "cup".
- 3) Reinstall the axle and front wheel.
- 4) Slide the second 45-0403FNRL over the threads of the axle as shown below. Install the axle nut and tighten.



Pucks: Slide 45-0403FNC spacer into the 45-0403FNRL base so that the cross drilled holes line up.

Important: One side of the puck and one side of the 45-0403FNC spacers have a small hole drilled beneath the main hole. Install the pin so that the end of the pin with the ball is on the same side as this small hole on bolt parts. The pin should be installed so that the ring is on the upper half of the slider.

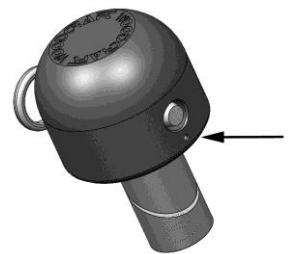

A Note for racers: If your tech inspector wants you to safety wire these (most will not) then you need to orient the pins so that the safety wire acts to pull the pin into the puck.

105 Baldwinville Rd, Winchendon, MA 01475

978-297-2977

WARNING: Improper installation and/or failure to comply with all warnings and instructions may cause a loss of control and serious injury or death. The motorcycle should be run and thoroughly inspected before use. DO NOT INSTALL OR USE THIS PRODUCT IF YOU ARE UNABLE TO DO SO IN COMPLIANCE WITH ALL INSTRUCTIONS AND WARNINGS. SEEK THE ASSISTANCE OF A TRAINED PROFESSIONAL TECHNICIAN