



YOSHIMURA

RESEARCH&DEVELOPMENT OF AMERICA, INC.

5420 DANIELS STREET STE A, CHINO CALIF. 91710 · (800)634-9166 · (909)628-4722 · FACSIMILE (909)591-2198

www.yoshimura-rd.com

Universal Turn Signal Bracket Kit

070BGUNVTBKT

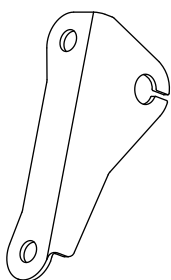
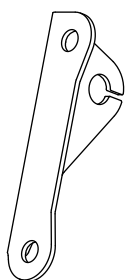

Up & Out

Turn signal mounted high and wide.

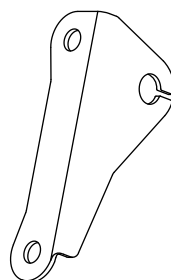

Up & In

Turn signal mounted high and narrow.

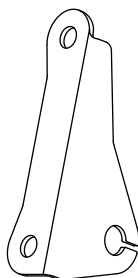
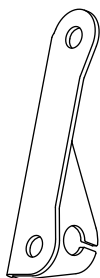

Down & Out

Turn signal mounted low and wide.

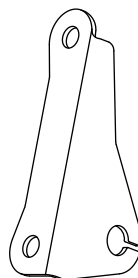

Down & In

Turn signal mounted low and narrow.

The Yoshimura Universal Turn Signal Brackets are to be used with aftermarket turn signals and can be installed using four different configurations. To prevent damage to turn signals, verify that the exhaust gases are not directed toward the turn signals. Yoshimura R&D of America, Inc. is not liable or responsible for any resulting event caused by the installation of this product. Check with local laws and regulations for compliance prior to installation and use.



● Thank you for purchasing **LED flash relay**. Before installing, please check the instruction carefully.

⚠ Notice

- For installation, please follow the steps described in manual. Any damage caused by wrong installation shall be imputed to the users.
- To avoid the short circuit, please don't pull the wire when installing. Don't break or modify the wire terminal.
- Do not disassemble or change any parts excluding the manual description. °
- The interior examination or maintenance should be executed by our professionals.

MARK MEANING:

NOTE You could get the installation details from the information behind the mark.

⚠ Some processes must be followed to avoid the affection acused by wrang installation.

WARNING! Some processes must be followed to avoid damages to youself or the public.

CAUTION! Some processes must be followed to avoid the damage to the vehicle.

1 Accessory

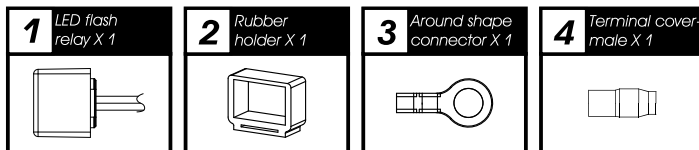

NOTE Please contact the local distributor if the items you open are not the same, with the above-listed one.

2 Wiring installation instructions

Ⓐ 2 PIN

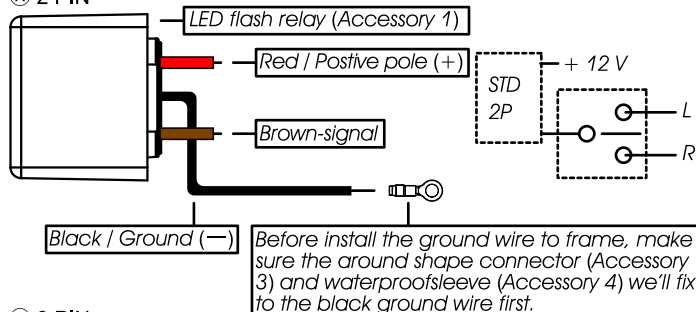

Ⓑ 3 PIN

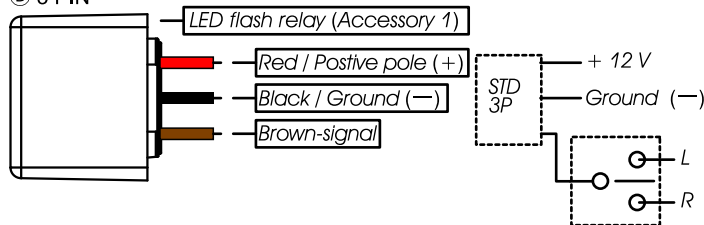

⚠ Be sure to take original flash relay out from bike after install new relay.

⚠ If the flash relay can not work properly. Please try to change red / brown position and try again.

Main switch wiring reference:

	Power	Key on	Ground		Power	Key on	Ground
YAMAHA	Red	Brown	Black	KYMC	Red	Black	Green
HONDA	Red	Red / Black	Green	SYM	Red	Black	Green
SUZUKI	Black	Green	Green	PGO	Red / White	Orange	Black
KAWASAKI	White	Brown	Black/yellow				

NOTE The color listed above may differ depending on the model.